

# Avída Towers

Altura

## Tower 1

as of

Monday, January 27, 2020

	LAGUNA DE BAY		LAGUNA		ALABANG										MAKATI SKYLINE		LAGUNA DE BAY						
Unit Type	2 BEDROOM		EXECUTIVE STUDIO		1 BEDROOM		STUDIO										1 BEDROOM		STUDIO				
Unit	1	2	3	4	5	6	7	8	9	10	11	12	14	15	16	17	18	19	20	21	22	23	
2F	1-201	1-202	1-203	1-204	1-205	1-206	1-207	1-208	1-209	1-210	1-211	1-212	1-214	1-215	1-216	1-217	1-218	1-219	1-220	1-221	1-222	1-223	
3F	1-301	1-302	1-303	1-304	1-305	1-306	1-307	1-308	1-309	1-310	1-311	1-312	1-314	1-315	1-316	1-317	1-318	1-319	1-320	1-321	1-322	1-323	
4F	1-401	1-402	1-403	1-404	1-405	1-406	1-407	1-408	1-409	1-410	1-411	1-412	1-414	1-415	1-416	1-417	1-418	1-419	1-420	1-421	1-422	1-423	
5F	1-501	1-502	1-503	1-504	1-505	1-506	1-507	1-508	1-509	1-510	1-511	1-512	1-514	1-515	1-516	1-517	1-518	1-519	1-520	1-521	1-522	1-523	
6F	1-601	1-602	1-603	1-604	1-605	1-606	1-607	1-608	1-609	1-610	1-611	1-612	1-614	1-615	1-616	1-617	1-618	1-619	1-620	1-621	1-622	1-623	
7F	1-701	1-702	1-703	1-704	1-705	1-706	1-707	1-708	1-709	1-710	1-711	1-712	1-714	1-715	1-716	1-717	1-718	1-719	1-720	1-721	1-722	1-723	
8F	1-801	1-802	1-803	1-804	1-805	1-806	1-807	1-808	1-809	1-810	1-811	1-812	1-814	1-815	1-816	1-817	1-818	1-819	1-820	1-821	1-822	1-823	
9F	1-901	1-902	1-903	1-904	1-905	1-906	1-907	1-908	1-909	1-910	1-911	1-912	1-914	1-915	1-916	1-917	1-918	1-919	1-920	1-921	1-922	1-923	
10F	1-1001	1-1002	1-1003	1-1004	1-1005	1-1006	1-1007	1-1008	1-1009	1-1010	1-1011	1-1012	1-1014	1-1015	1-1016	1-1017	1-1018	1-1019	1-1020	1-1021	1-1022	1-1023	
11F	1-1101	1-1102	1-1103	1-1104	1-1105	1-1106	1-1107	1-1108	1-1109	1-1110	1-1111	1-1112	1-1114	1-1115	1-1116	1-1117	1-1118	1-1119	1-1120	1-1121	1-1122	1-1123	
12F	1-1201	1-1202	1-1203	1-1204	1-1205	1-1206	1-1207	1-1208	1-1209	1-1210	1-1211	1-1212	1-1214	1-1215	1-1216	1-1217	1-1218	1-1219	1-1220	1-1221	1-1222	1-1223	
14F	1-1401	1-1402	1-1403	1-1404	1-1405	1-1406	1-1407	1-1408	1-1409	1-1410	1-1411	1-1412	1-1414	1-1415	1-1416	1-1417	1-1418	1-1419	1-1420	1-1421	1-1422	1-1423	
15F	1-1501	1-1502	1-1503	1-1504	1-1505	1-1506	1-1507	1-1508	1-1509	1-1510	1-1511	1-1512	1-1514	1-1515	1-1516	1-1517	1-1518	1-1519	1-1520	1-1521	1-1522	1-1523	
16F	1-1601	1-1602	1-1603	1-1604	1-1605	1-1606	1-1607	1-1608	1-1609	1-1610	1-1611	1-1612	1-1614	1-1615	1-1616	1-1617	1-1618	1-1619	1-1620	1-1621	1-1622	1-1623	
17F	1-1701	1-1702	1-1703	1-1704	1-1705	1-1706	1-1707	1-1708	1-1709	1-1710	1-1711	1-1712	1-1714	1-1715	1-1716	1-1717	1-1718	1-1719	1-1720	1-1721	1-1722	1-1723	
18F	1-1801	1-1802	1-1803	1-1804	1-1805	1-1806	1-1807	1-1808	1-1809	1-1810	1-1811	1-1812	1-1814	1-1815	1-1816	1-1817	1-1818	1-1819	1-1820	1-1821	1-1822	1-1823	
19F	1-1901	1-1902	1-1903	1-1904	1-1905	1-1906	1-1907	1-1908	1-1909	1-1910	1-1911	1-1912	1-1914	1-1915	1-1916	1-1917	1-1918	1-1919	1-1920	1-1921	1-1922	1-1923	
20F	1-2001	1-2002	1-2003	1-2004	1-2005	1-2006	1-2007	1-2008	1-2009	1-2010	1-2011	1-2012	1-2014	1-2015	1-2016	1-2017	1-2018	1-2019	1-2020	1-2021	1-2022	1-2023	
21F	1-2101	1-2102	1-2103	1-2104	1-2105	1-2106	1-2107	1-2108	1-2109	1-2110	1-2111	1-2112	1-2114	1-2115	1-2116	1-2117	1-2118	1-2119	1-2120	1-2121	1-2122	1-2123	
22F	1-2201	1-2202	1-2203	1-2204	1-2205	1-2206	1-2207	1-2208	1-2209	1-2210	1-2211	1-2212	1-2214	1-2215	1-2216	1-2217	1-2218	1-2219	1-2220	1-2221	1-2222	1-2223	
23F	1-2301	1-2302	1-2303	1-2304	1-2305	1-2306	1-2307	Jan-08	1-2309	1-2310	1-2311	1-2312	1-2314	1-2315	1-2316	1-2317	1-2318	1-2319	1-2320	1-2321	1-2322	1-2323	

AVL
SOLD

Note: Please double check unit type/description to our Official Pricelist

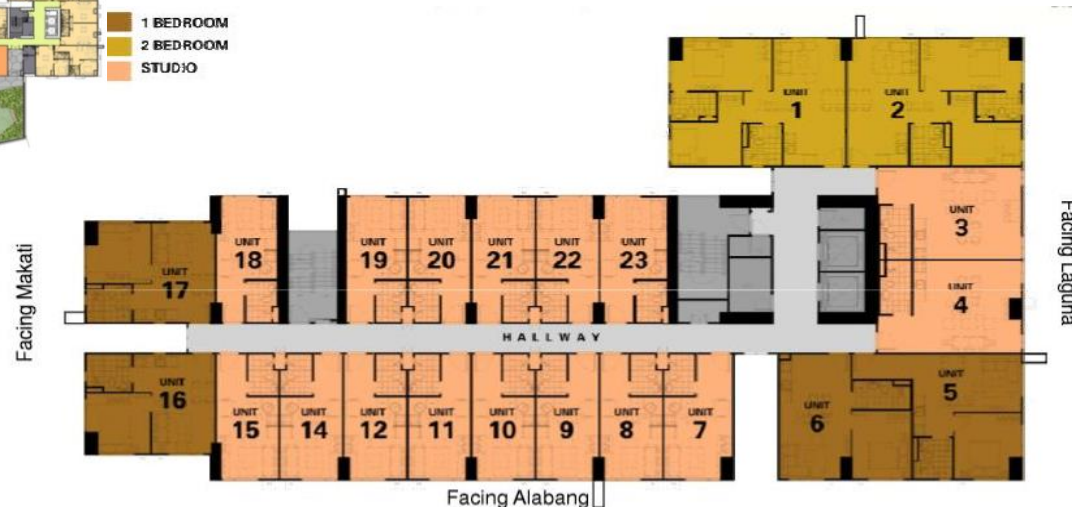

as of **Monday, January 27, 2020**

Unit Type	FACING ALABANG CBD										FACING MAKATI						FACING AMENITIES									
	1 BR	STUDIO								1 BR	1 BR	STUDIO				1 BR	2 BR	1 BR	STUDIO					2 BR		
Unit		3	4	5	6	7	8	9	10	11	12	14	15	16	17	18	19	20	21	22	23	24	25	26	27	
4F		2-402	2-403	2-404	2-405	2-406	2-407	2-408	2-409	2-410	2-411	2-412	2-414	2-415	2-416	2-417	2-418	2-419	2-420	2-421	2-422	2-423	2-424	2-425	2-426	2-427
5F	2-501	2-502	2-503	2-504	2-505	2-506	2-507	2-508	2-509	2-510	2-511	2-512	2-514	2-515	2-516	2-517	2-518	2-519	2-520	2-521	2-522	2-523	2-524	2-525	2-526	2-527
6F	2-601	2-602	2-603	2-604	2-605	2-606	2-607	2-608	2-609	2-610	2-611	2-612	2-614	2-615	2-616	2-617	2-618	2-619	2-620	2-621	2-622	2-623	2-624	2-625	2-626	2-627
7F	2-701	2-702	2-703	2-704	2-705	2-706	2-707	2-708	2-709	2-710	2-711	2-712	2-714	2-715	2-716	2-717	2-718	2-719	2-720	2-721	2-722	2-723	2-724	2-725	2-726	2-727
8F	2-801	2-802	2-803	2-804	2-805	2-806	2-807	2-808	2-809	2-810	2-811	2-812	2-814	2-815	2-816	2-817	2-818	2-819	2-820	2-821	2-822	2-823	2-824	2-825	2-826	2-827
9F	2-901	2-902	2-903	2-904	2-905	2-906	2-907	2-908	2-909	2-910	2-911	2-912	2-914	2-915	2-916	2-917	2-918	2-919	2-920	2-921	2-922	2-923	2-924	2-925	2-926	2-927
10F	2-1001	2-1002	2-1003	2-1004	2-1005	2-1006	2-1007	2-1008	2-1009	2-1010	2-1011	2-1012	2-1014	2-1015	2-1016	2-1017	2-1018	2-1019	2-1020	2-1021	2-1022	2-1023	2-1024	2-1025	2-1026	2-1027
11F	2-1101	2-1102	2-1103	2-1104	2-1105	2-1106	2-1107	2-1108	2-1109	2-1110	2-1111	2-1112	2-1114	2-1115	2-1116	2-1117	2-1118	2-1119	2-1120	2-1121	2-1122	2-1123	2-1124	2-1125	2-1126	2-1127
12F	2-1201	2-1202	2-1203	2-1204	2-1205	2-1206	2-1207	2-1208	2-1209	2-1210	2-1211	2-1212	2-1214	2-1215	2-1216	2-1217	2-1218	2-1219	2-1220	2-1221	2-1222	2-1223	2-1224	2-1225	2-1226	2-1227
14F	2-1401	2-1402	2-1403	2-1404	2-1405	2-1406	2-1407	2-1408	2-1409	2-1410	2-1411	2-1412	2-1414	2-1415	2-1416	2-1417	2-1418	2-1419	2-1420	2-1421	2-1422	2-1423	2-1424	2-1425	2-1426	2-1427
15F	2-1501	2-1502	2-1503	2-1504	2-1505	2-1506	2-1507	2-1508	2-1509	2-1510	2-1511	2-1512	2-1514	2-1515	2-1516	2-1517	2-1518	2-1519	2-1520	2-1521	2-1522	2-1523	2-1524	2-1525	2-1526	2-1527
16F	2-1601	2-1602	2-1603	2-1604	2-1605	2-1606	2-1607	2-1608	2-1609	2-1610	2-1611	2-1612	2-1614	2-1615	2-1616	2-1617	2-1618	2-1619	2-1620	2-1621	2-1622	2-1623	2-1624	2-1625	2-1626	2-1627
17F	2-1701	2-1702	2-1703	2-1704	2-1705	2-1706	2-1707	2-1708	2-1709	2-1710	2-1711	2-1712	2-1714	2-1715	2-1716	2-1717	2-1718	2-1719	2-1720	2-1721	2-1722	2-1723	2-1724	2-1725	2-1726	2-1727
18F	2-1801	2-1802	2-1803	2-1804	2-1805	2-1806	2-1807	2-1808	2-1809	2-1810	2-1811	2-1812	2-1814	2-1815	2-1816	2-1817	2-1818	2-1819	2-1820	2-1821	2-1822	2-1823	2-1824	2-1825	2-1826	2-1827
19F	2-1901	2-1902	2-1903	2-1904	2-1905	2-1906	2-1907	2-1908	2-1909	2-1910	2-1911	2-1912	2-1914	2-1915	2-1916	2-1917	2-1918	2-1919	2-1920	2-1921	2-1922	2-1923	2-1924	2-1925	2-1926	2-1927
20F	2-2001	2-2002	2-2003	2-2004	2-2005	2-2006	2-2007	2-2008	2-2009	2-2010	2-2011	2-2012	2-2014	2-2015	2-2016	2-2017	2-2018	2-2019	2-2020	2-2021	2-2022	2-2023	2-2024	2-2025	2-2026	2-2027
21F	2-2101	2-2102	2-2103	2-2104	2-2105	2-2106	2-2107	2-2108	2-2109	2-2110	2-2111	2-2112	2-2114	2-2115	2-2116	2-2117	2-2118	2-2119	2-2120	2-2121	2-2122	2-2123	2-2124	2-2125	2-2126	2-2127
22F	2-2201	2-2202	2-2203	2-2204	2-2205	2-2206	2-2207	2-2208	2-2209	2-2210	2-2211	2-2212	2-2214	2-2215	2-2216	2-2217	2-2218	2-2219	2-2220	2-2221	2-2222	2-2223	2-2224	2-2225	2-2226	2-2227
23F	2-2301	2-2302	2-2303	2-2304	2-2305	2-2306	2-2307	2-2308	2-2309	2-2310	2-2311	2-2312	2-2314	2-2315	2-2316	2-2317	2-2318	2-2319	2-2320	2-2321	2-2322	2-2323	2-2324	2-2325	2-2326	2-2327
24F	2-2401	2-2402	2-2403	2-2404	2-2405	2-2406	2-2407	2-2408	2-2409	2-2410	2-2411	2-2412	2-2414	2-2415	2-2416	2-2417	2-2418	2-2419	2-2420	2-2421	2-2422	2-2423	2-2424	2-2425	2-2426	2-2427
25F	2-2501	2-2502	2-2503	2-2504	2-2505	2-2506	2-2507	2-2508	2-2509	2-2510	2-2511	2-2512	2-2514	2-2515	2-2516	2-2517	2-2518	2-2519	2-2520	2-2521	2-2522	2-2523	2-2524	2-2525	2-2526	2-2527
26F	2-2601	2-2602	2-2603	2-2604	2-2605	2-2606	2-2607	Jan-08	2-2609	2-2610	2-2611	2-2612	2-2614	2-2615	2-2616	2-2617	2-2618	2-2619	2-2620	2-2621	2-2622	2-2623	2-2624	2-2625	2-2626	2-2627
27F	2-2701	2-2702	2-2703	2-2704	2-2705	2-2706	2-2707	2-2708	2-2709	2-2710	2-2711	2-2712	2-2714	2-2715	2-2716	2-2717	2-2718	2-2719	2-2720	2-2721	2-2722	2-2723	2-2724	2-2725	2-2726	2-2727
28F	2-2801	2-2802	2-2803	2-2804	2-2805	2-2806	2-2807	2-2808	2-2809	2-2810	2-2811	2-2812	2-2814	2-2815	2-2816	2-2817	2-2818	2-2819	2-2820	2-2821	2-2822					

AVL
SOLD

Note: Please double check unit type/description to our Official Pricelist



**AVIDA TOWERS ALTURA TOWER 1 & 2**

Pricelist as of Monday, January 27, 2020

**2019 STANDARD PAYTERM**

<b>SPOT CASH</b>	5% disc (30days) 4% disc (60days)
<b>BANK FIN/ LUMPSUM</b>	10% Spot 10% in 6mos with Bank/Lumpsum (5% disc)

<b>Project</b>	<b>Unit</b>	<b>Model</b>	<b>Floor Area</b>	<b>Selling Price</b>
AT ALTURA	1-221	STUDIO	22.4	3,824,800
AT ALTURA	1-404	STUDIO	37.7	6,472,480
AT ALTURA	1-504	STUDIO	37.7	6,482,560
AT ALTURA	1-1002	2 BEDROOM	63.19	10,960,320
AT ALTURA	1-1804	STUDIO	37.7	6,597,920
AT ALTURA	1-2101	2 BEDROOM	63.58	11,175,360
AT ALTURA	2-1001	1 BEDROOM	37.49	6,219,000
AT ALTURA	2-1515	STUDIO	22.4	3,933,000
AT ALTURA	2-2805	STUDIO	22.4	4,020,000

**PARKING SLOT AVIDA TOWERS ALTURA TOWER 1 & 2**

**Taken**

Monday, January 27, 2020

**Available**

<b>ALTURA TOWER 1 PARKING SLOT</b>						
Selling Price: P 1,000,000						
<b>TOWER 1</b>			<b>TOWER 2</b>			
1-1P01	1-2P01	1-2P50	2-1P01	2-1P50	2-2P31	2-G09
1-1P02	1-2P02	1-2P51	2-1P02	2-1P51	2-2P32	2-G10
1-1P03	1-2P03	1-2P52	2-1P03	2-1P52	2-2P33	2-G11
1-1P04	1-2P04	1-2P53	2-1P04	2-1P53	2-2P34	2-G12
1-1P05	1-2P05	1-2P54	2-1P05	2-1P54	2-2P35	2-G13
1-1P06	1-2P06	1-G02	2-1P06	2-1P55	2-2P36	2-G14
1-1P07	1-2P07	1-G03	2-1P07	2-1P56	2-2P37	2-G15
1-1P08	1-2P08	1-G05	2-1P08	2-1P57	2-2P38	2-G16
1-1P09	1-2P09	1-G06	2-1P09	2-1P58	2-2P39	2-G17
1-1P10	1-2P10	1-G07	2-1P10	2-1P59	2-2P40	2-G18
1-1P11	1-2P11	1-G08	2-1P11	2-1P60	2-2P41	2-G19
1-1P12	1-2P12	1-G09	2-1P12	2-1P61	2-2P42	2-G20
1-1P13	1-2P13	1-G10	2-1P13	2-1P62	2-2P43	2-G21
1-1P14	1-2P14	1-G11	2-1P14	2-1P63	2-2P44	2-G22
1-1P15	1-2P15	1-G12	2-1P15	2-1P64	2-2P45	2-G23
1-1P16	1-2P16	1-G13	2-1P16	2-1P65	2-2P46	2-G24
1-1P17	1-2P17	1-G14	2-1P17	2-1P66	2-2P47	2-G25
1-1P18	1-2P18	1-G15	2-1P18	2-1P67	2-2P48	2-G26
1-1P19	1-2P19	1-G16	2-1P19	2-1P68	2-2P49	2-G27
1-1P20	1-2P20	1-G17	2-1P20	2-2P01	2-2P50	2-G28
1-1P21	1-2P21	1-G18	2-1P21	2-2P02	2-2P51	2-G29
1-1P23	1-2P22	1-G19	2-1P22	2-2P03	2-2P52	Jan-08
1-1P24	1-2P23	1-G20	2-1P23	2-2P04	2-2P53	2-G31
1-1P25	1-2P24	1-G21	2-1P24	2-2P05	2-2P54	2-G32
1-1P26	1-2P25	1-G22	2-1P25	2-2P06	2-2P55	2-G33
1-1P27	1-2P26	1-G23	2-1P26	2-2P07	2-2P56	2-G34
1-1P28	1-2P27	1-G24	2-1P27	2-2P08	2-2P57	2-G35
1-1P30	1-2P28	1-G25	2-1P28	2-2P09	2-2P58	2-G36
1-1P31	1-2P29	1-G26	2-1P29	2-2P10	2-2P59	2-G37
1-1P32	1-2P30	1-G27	2-1P30	2-2P11	2-2P60	2-G38
1-1P33	1-2P31	1-G28	2-1P31	2-2P12	2-2P61	2-G39
1-1P34	1-2P32	1-G29	2-1P32	2-2P13	2-2P62	2-G40
1-1P35	1-2P33	1-G30	2-1P33	2-2P14	2-2P63	2-G41
1-1P36	1-2P34	1-G31	2-1P34	2-2P15	2-2P64	2-G42
1-1P37	1-2P35	1-G32	2-1P35	2-2P16	2-2P65	2-G43
1-1P38	1-2P36	1-G33	2-1P36	2-2P17	2-2P66	2-G44
1-1P39	1-2P37	1-G34	2-1P37	2-2P18	2-2P67	2-G45
1-1P40	1-2P38	1-G35	2-1P38	2-2P19	2-2P68	2-G46
1-1P41	1-2P39	1-G36	2-1P39	2-2P20	2-2P69	2-G47
1-1P42	1-2P40	1-G37	2-1P40	2-2P21	2-2P70	2-G48
1-1P43	1-2P41	1-G38	2-1P41	2-2P22	2-2P71	2-G49
1-1P44	1-2P42	1-G39	2-1P42	2-2P23	2-G01	2-G50
1-1P45	1-2P43	1-G40	2-1P43	2-2P24	2-G02	2-G51
1-1P46	1-2P44	1-G41	2-1P44	2-2P25	2-G03	2-G52
1-1P47	1-2P45		2-1P45	2-2P26	2-G04	
1-1P48	1-2P46		2-1P46	2-2P27	2-G05	
1-1P49	1-2P47		2-1P47	2-2P28	2-G06	
1-1P50	1-2P48		2-1P48	2-2P29	2-G07	
1-1P51	1-2P49		2-1P49	2-2P30	2-G08	