

A photograph of a sailboat on the ocean during sunset. The scene is bathed in a warm, golden light. A large, light-colored sail is partially visible on the left side of the frame. A person is standing on the deck in the middle ground, looking towards the horizon. The water is dark with some whitecaps, and the sky is a mix of orange and yellow. The overall mood is serene and adventurous.

The World Is Theirs to Explore



In Control



Empowered

A photograph of a sailboat on the ocean during sunset. The scene is bathed in a warm, golden light. A large, light-colored sail is partially visible on the left side of the frame. A person is standing on the deck in the middle ground, looking towards the horizon. The water is dark with some whitecaps, and the sky is a mix of orange and yellow. The overall mood is serene and adventurous.

Many Opportunities



Many Choices



Privileged

A photograph of a sailboat on the ocean during sunset. The scene is bathed in a warm, golden light. A large, light-colored sail is partially visible on the left side of the frame. A person is standing on the deck in the middle ground, looking towards the right. The water is dark with some whitecaps, and the sky is a mix of orange and yellow. The overall mood is serene and luxurious.

A premium condominium development
that provides Luxurious Living in a
World-Class Destination

Our Development



SAIL
RESIDENCES
MALL OF ASIA, PASAY CITY



- Address: Sunrise Drive, MOA Complex, Pasay City
- Lot Area: 22,000 SQM
- Total no. of Units: 2,829
- Price Range: Php. 8 Mn – 28 Mn

Our Development



SAIL
RESIDENCES
MALL OF ASIA, PASAY CITY

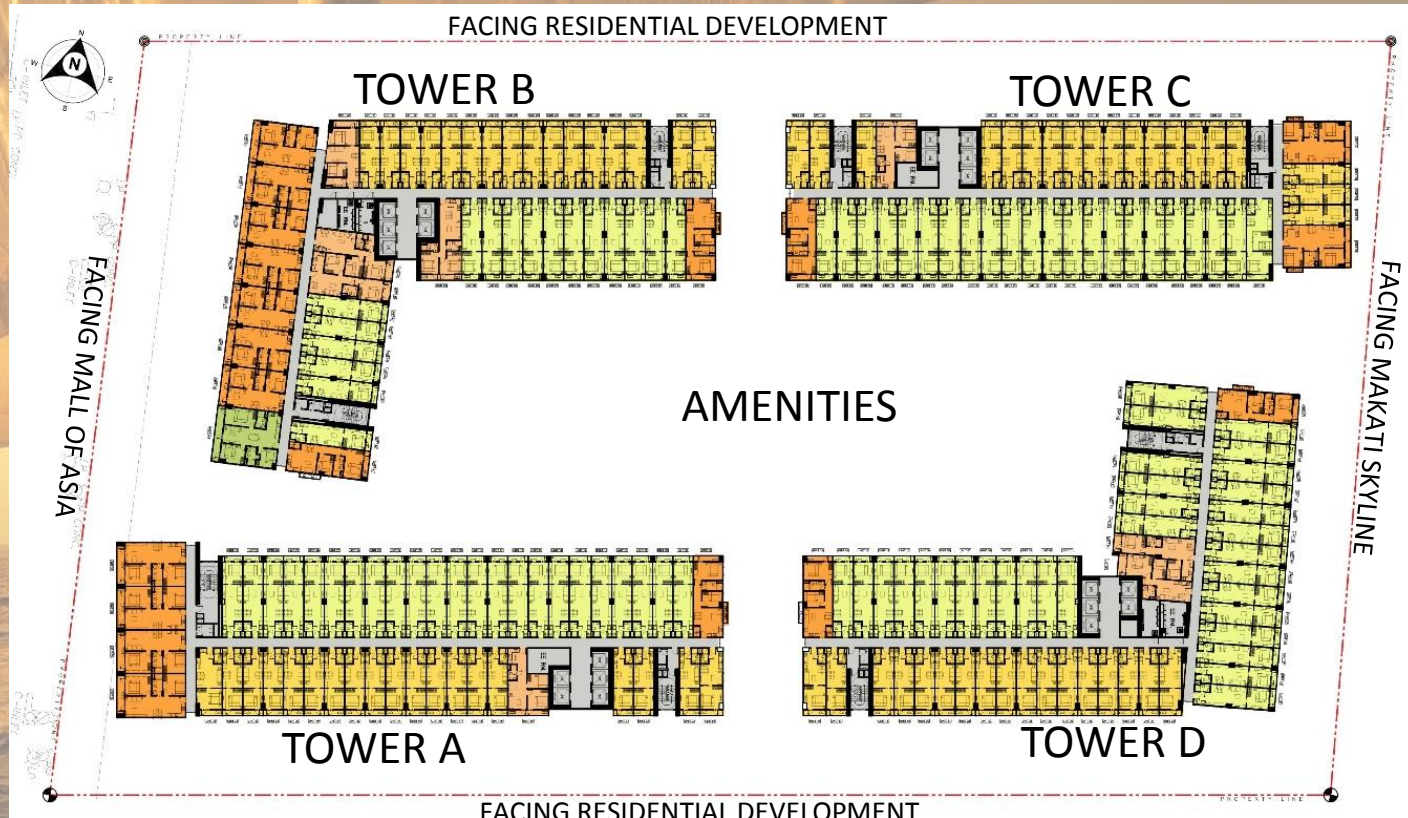

- The project is a 16 storey, 4-tower mixed used development that offers **retail/commercial spaces** at the ground floor level.
- Parking is located on the basement and ground floor.

Our Development – Tower A



FACING MANILA BAY

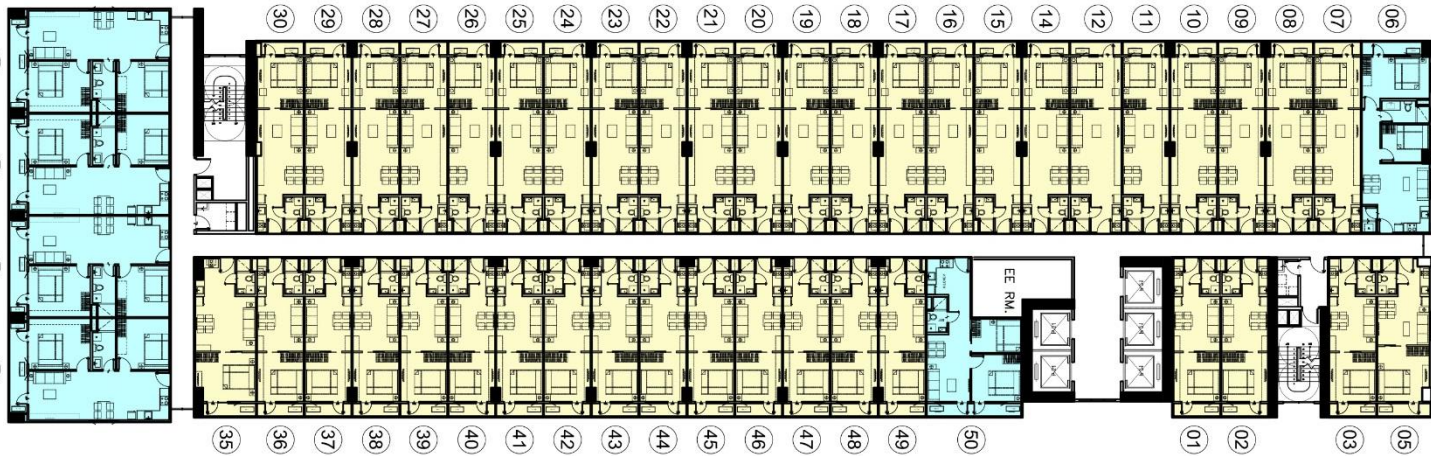

FACING AMENITY VIEW

FACING RESIDENTIAL DEVELOPMENT

SAIL
RESIDENCES
MALL OF ASIA, PASAY CITY

Our Development – Tower B



SAIL
RESIDENCES
MALL OF ASIA, PASAY CITY

FACING MANILA BAY

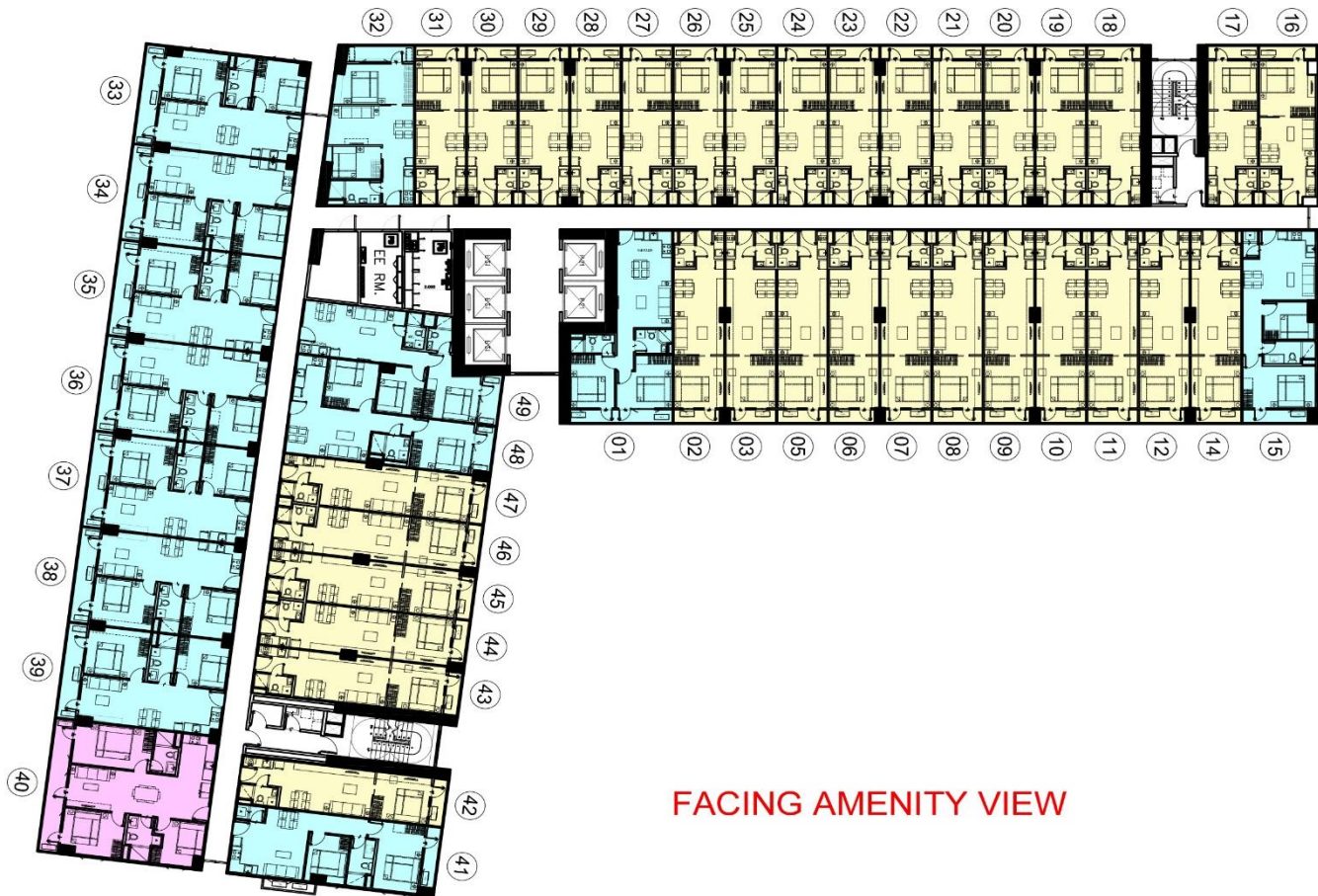

FACING RESIDENTIAL DEVELOPMENT

FACING AMENITY VIEW

Our Development – Tower C



SAIL
RESIDENCES
MALL OF ASIA, PASAY CITY

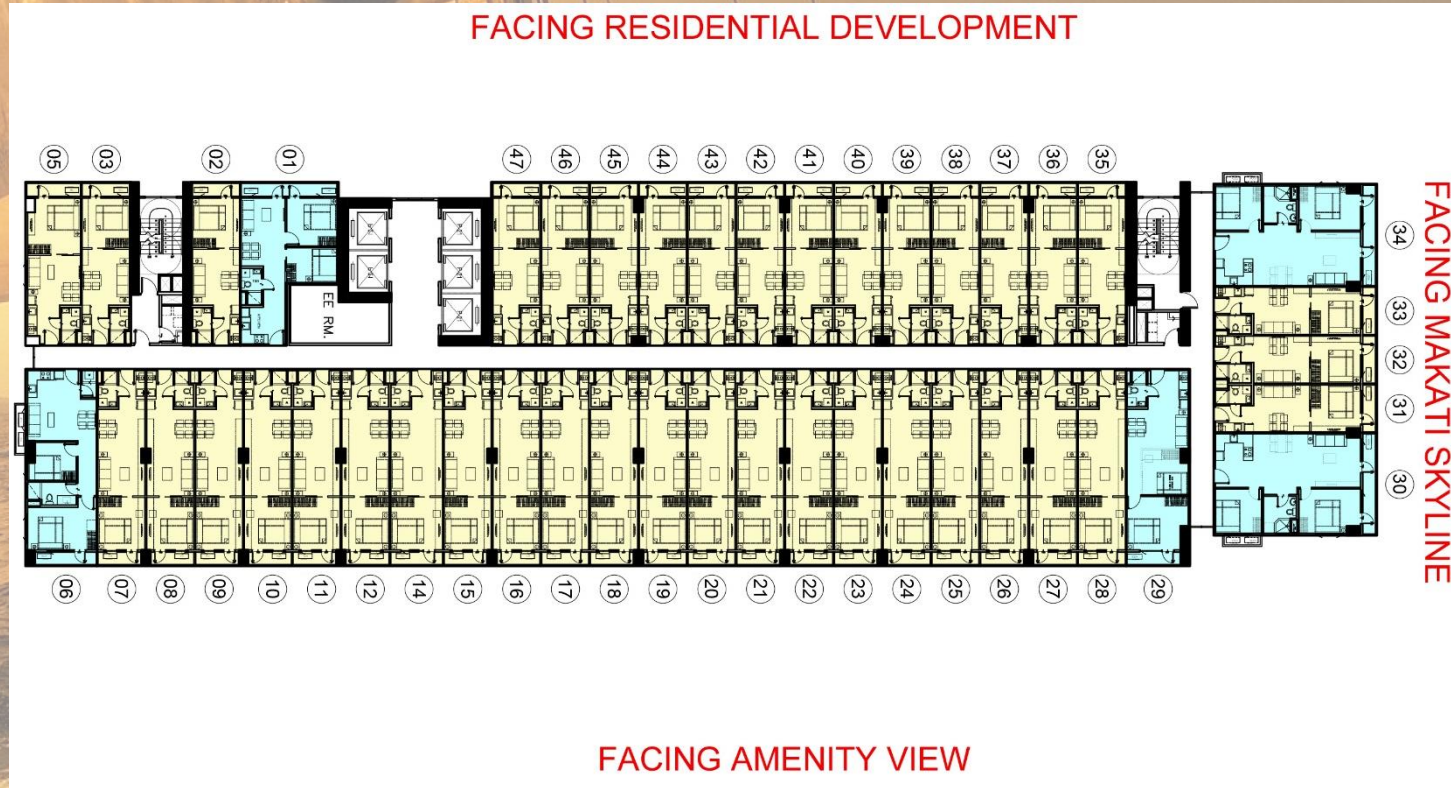

Our Development – Tower D

FACING AMENITY VIEW



FACING RESIDENTIAL DEVELOPMENT

FACING MAKATI SKYLINE



SAIL
RESIDENCES
MALL OF ASIA, PASAY CITY

A photograph of a sailboat on the water during sunset. The scene is bathed in a warm, golden light. A large, light-colored sail is partially visible on the left side of the frame. A person is standing on the deck in the middle ground, looking towards the horizon. The water is dark with some whitecaps, and the sky is a mix of orange and yellow. The overall mood is serene and adventurous.

Our Target Market

End-Users

Who are they:

Very successful people in their own field, earning P300-P350K net a month. Have attained a certain level of sophistication because of their corporate or entrepreneurial accomplishments coupled with their being well traveled. Married with a very young kid. Holds office in Makati or has their own business in that area. Puts a premium on the “quality” of neighborhood they belong to.

What do we want to communicate to them:

At **Sail Residences**, you can enjoy the **Privileged Life**.

Reasons to Believe:

In the heart of the 21st- century bayside business and entertainment district rises the pride of all SMDC premier projects in MOA. This is an exclusive premium condo development, with pristine open spaces, world class amenities and luxurious living spaces that is perfect for your discerning family.

The world is yours to explore.



End-Users

Who are they:

Single males, working as an executive in one of the E-com buildings, earning P250K-P300K net a month. Very successful people in their own field and have attained a certain level of sophistication because of their corporate accomplishments coupled with their being well traveled.

What do we want to communicate to them:

At **Sail Residences**, you can enjoy the **Privileged Life**.

Reasons to Believe:

In the heart of the 21st- century bayside business and entertainment district rises the pride of all SMDC premier projects in MOA. This is an exclusive premium condo development, with pristine open spaces, world class amenities and luxurious living spaces that is perfect for the discerning you.

The world is yours to explore.



End-Users

Who are they:

Single female entrepreneurs who are very successful in their business, earning P250K-P300K net a month. They have attained a certain level of sophistication because of their accomplishments coupled with their being well traveled. Quite sociable with their peers and enjoys being close to the night-life.

What do we want to communicate to them:

At **Sail Residences**, you can enjoy the **Privileged Life**.

Reasons to Believe:

In the heart of the 21st- century bayside business and entertainment district rises the pride of all SMDC premier projects in MOA. This is an exclusive premium condo development, with pristine open spaces, world class amenities and luxurious living spaces that is perfect for the discerning you.

The world is yours to explore.



A photograph of a sailboat on the water during sunset. The scene is bathed in a warm, golden light. A large, light-colored sail is partially visible on the left side of the frame. A person is standing on the deck in the middle ground, looking towards the horizon. The water is dark with some whitecaps, and the sky is a mix of orange and yellow. The overall mood is serene and adventurous.

What kind of a lifestyle will they experience?

Buyer Experience



Prime
Location



Flexible
Living
Spaces

Buyer



Concierge
Serviced
Lifestyle



Country
Club
Amenities

Buyer Experience

Prime Location

Being in the center of the 21st Century Bayside District, our buyers will have a PRIVILEGED LIFE, because they will have ACCESS to WORLD-CLASS EXPERIENCES. Shop, Dine, Live, Work & Play like no other.



In the heart of the 21st- century Bayside Business and Entertainment that is both a livable and walkable community that provides...

- World-Class Dining
- World-Class Shopping
- World-Class Entertainment
- World-Class Destinations
- World-Class Working Environment

Buyer Experience

Flexible Living Spaces

- Well-thought out personal living spaces that allows you to explore what best suits your lifestyle.
- Bigger units, 32.16 sqm., 38.75 sqm., 61.69 sqm. and 86.07 sqm.
- Can combine units to provide lavishly luxurious spaces for your family.
- Low density per floor , giving you the privacy that you long for.



32.16 sqm- 1 BR w/ balcony



38.75 sqm- 1 BR w/ balcony

Buyer Experience

Flexible Living Spaces

- Well-thought out personal living spaces that allows you to explore what best suits your lifestyle.
- Bigger units, 32.16 sqm., 38.75 sqm., 61.69 sqm. and 86.07 sqm.
- Can combine units to provide lavishly luxurious spaces for your family.
- Low density per floor , giving you the privacy that you long for.



61.69 sqm- 2 BR w/ balcony



86.07 sqm- 3BR w/ balcony

Buyer Experience



Lobby and Lounge Area

- High-grade finishes
- Bespoke furnishings
- Sail inspired decor

Buyer Experience

Country Club Amenities

- Our clubhouse and gym will be in the middle of our maritime inspired pool, giving you a better view of the crystal clear waters and topiaries.
- Also our cabana like areas will be around the pool making celebrations more enjoyable.



High-end Country Club amenities:

Clubhouse with luxurious lounge areas and a full gym at the second floor.

Separate cabana like areas for special functions or occasions.

Crystal clear pool

Jacuzzis

Kiddie Playground

Palm Terraces Walkways

Central Garden

Sailboat Fountain

Amenities to be enjoyed solely by you and your family.

Buyer Experience

Country Club Amenities

- Our clubhouse and gym will be in the middle of our maritime inspired pool, giving you a better view of the crystal clear waters and topiaries.
- Also our cabana like areas will be around the pool making celebrations more enjoyable.



Clubhouse with luxurious lounge areas and a full gym at the second floor.





Buyer Experience



Our commercial area
will house various
concessionaires
apt for the discerning
taste of our
homeowners.



Buyer Experience

Concierge Serviced Lifestyle

- Provides living experience that is convenient, comfortable and secure; elevating the lifestyle of homeowners and residents of its managed properties.
- First-class facility maintenance, management and safety.

**Professional
Property
Management**

GREENMIST
PROPERTY MANAGEMENT CORP.

SMDC
LEASING



A photograph of a sailboat on the ocean during sunset. The scene is bathed in a warm, golden light. A large, light-colored sail is partially visible on the left side of the frame. A person is standing on the deck in the middle ground, looking towards the horizon. The water is dark with some whitecaps, and the sky is a mix of orange and yellow. The overall mood is serene and adventurous.

Now, the World Is Yours to Explore

A photograph of a sailboat on the water during a golden hour, likely sunrise or sunset. The scene is bathed in warm, orange light. A large, light-colored sail is partially visible on the left side of the frame. A person is standing on the deck in the middle ground, looking towards the right. The water is dark with some whitecaps, and the sky is a uniform golden color. The overall mood is peaceful and serene.

Happy Selling and Good Morning!