



URBAN SPIRIT.

SOUTHERN SOUL.

Avida Towers
Ardane

South Park

DISTRICT

Avida Towers Altura	7,226 sqm. 1,054 units
Avida Towers Ardane	6,829 sqm. 1,914 units
Ayala Mall South Park	19,311 sqm.
Corporate Center	
Future Developments	12,981 sqm.
Residential Park	19,088 sqm.
Grand Lawn	
Other Common Areas	



Ayala Malls
SOUTH PARK

Avida Towers
Altura

Avida Towers
Ardane



EXPERIENCE SOUTHERN LIVING AT ITS BEST

The 6.6 hectare development brings together a mix of residential condos, a mall, and an office building. At its center is an expansive park and open spaces where people can stroll and enjoy the laid-back vibe of the South. South Park District will be a venue for convergence on this side of Muntinlupa that embraces a unique experience, bringing to life a place that's Part city. Part nature. Pure South.



Artist's Perspective



Avida Towers Ardane

Located within the thriving community of Ayala Land's South Park District, Avida's first large-scale, master planned, mixed-use development, Avida Towers Ardane brings together the excitement of the CBD and the comfort of the South for a living experience like no other.

GENERAL INFORMATION

Tower 1

NO. OF FLOORS:

29 RESIDENTIAL & 4 PARKING PODIUMS

NO. OF UNITS PER FLOOR: 33

RESIDENTIAL UNIT OFFERINGS (PER FLOOR):

19 STUDIO, 10 JR. 1-BR, 4 1-BR

TOTAL RESIDENTIAL UNITS: 957

NO. OF ELEVATORS: 4

RESIDENTIAL PARKING SLOTS:

271 (TOWER 1)

A woman in a black tank top is the central figure, looking down at a white smartphone she is holding. She is wearing white earbuds and a black smartwatch. In the background, two other women are standing outdoors near some greenery, smiling and looking at the phone. The setting appears to be a modern gym or fitness center with treadmills visible in the background.

FROM FUN

TO FUNCTIONAL

AMENITIES

Hang out with friends at the lounge, or outdo yourself at the gym. Soak up the sun by the pool, or bond with your kids at the play area. There's a little bit of everything for everyone!

- Open Lounges
- Children's Play Area
- Adult Pool
- Kiddie Pool
- Indoor Gym
- Clubhouse

SITE DEVELOPMENT PLAN
Facing Laguna de Bay

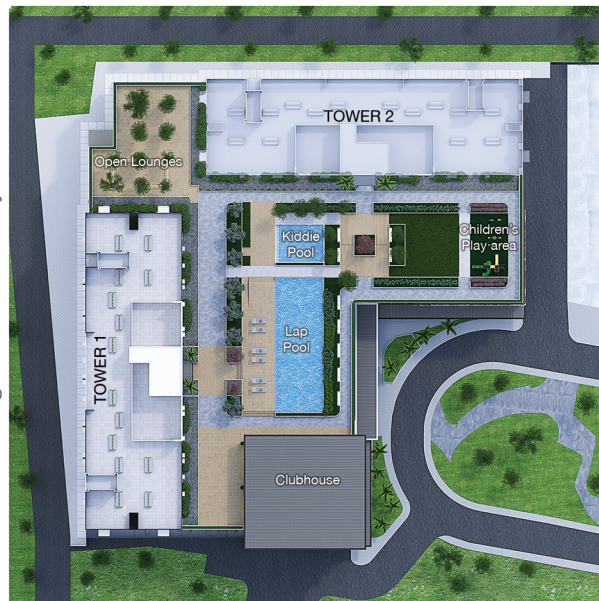

Facing Alabang Skyline



Artist's Perspective



Artist's Perspective



Artist's Perspective

A woman with dark hair pulled back, smiling, wearing a white blazer over a white dress. She is holding a small black quilted clutch bag with a gold clasp. The background is a composite image. On the left, a modern multi-story apartment building with many balconies is shown against a teal sky with palm fronds. On the right, a bedroom interior is visible, featuring a bed with white and grey pillows, a white blanket, and a wire basket on the floor. On the wall behind her are a round wooden clock and a large teardrop-shaped mirror.

YOUR DREAM.

YOUR REALITY.

UNITS

Turn your dream space into a reality with Avida Towers Ardane's master-planned, right-sized units.

Our range of Studio, Junior 1 Bedroom, and 1 Bedroom units complement any lifestyle, making it a place one can truly call home.



TYPICAL FLOOR PLAN

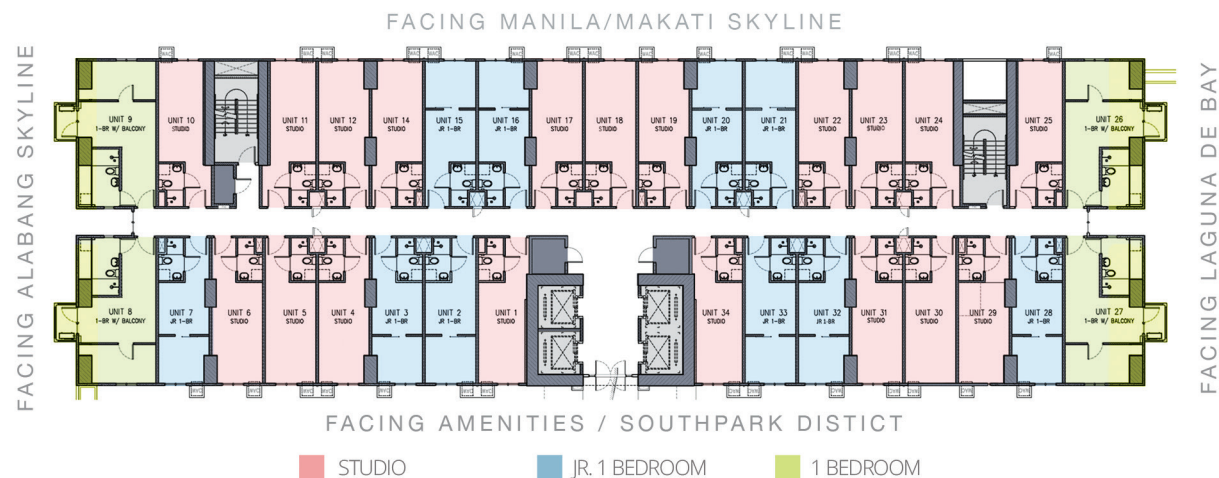

UNIT FLOOR PLAN



STUDIO*

STUDIO	SQ.M.
Living/Dining/Kitchen	19.80
Toilet and Bath	3.50
Estimated Total Area	23.30

JR 1 BEDROOM*

JR 1 BEDROOM	SQ.M.
Living/Dining/Kitchen	12.10
Toilet and Bath	3.50
Bedroom	7.70
Estimated Total Area	23.30

1 BEDROOM*

1 BEDROOM	SQ.M.
Living/Dining/Kitchen	19.10
Toilet and Bath	5.30
Bedroom	11.30
Balcony	2.50
Estimated Total Area	38.2

*Artist's Perspective



Address

South Park District, National Road,
Alabang, Muntinlupa City

Owner and Developer

Avida Land Corp.

Completion Date

July 30, 2025 (Tower 1)

Turnover Date

August 2025 (Tower 1)

Visit avidaland.com for construction updates

avidaland.com    avidalandph

Property managed by

AYALA PROPERTY MANAGEMENT CORPORATION

Should you choose to rent out your unit,

THE AVIDA LEASING TEAM can assist you.

HLURB LS NO. 035184
DHSUD NCR AA-2020/01-2697