

Artist's Perspective

Avida Towers Ardane

Located within the thriving community of Ayala Land's South Park District, the large-scale, master planned and Avida's first mixed-use development, **Avida Towers Ardane** brings together the excitement of the CBD and the comfort of the South for a living experience like no other.

GENERAL INFORMATION

Tower 1

NO. OF FLOORS:
29 RESIDENTIAL & 4 PARKING PODIUMS

NO. OF UNITS PER FLOOR: 33

RESIDENTIAL UNIT OFFERINGS
(PER FLOOR): 19 STUDIO, 10 JR. 1-BR, 4 1-BR

TOTAL RESIDENTIAL UNITS: 957

NO. OF ELEVATORS: 4

RESIDENTIAL PARKING SLOTS:
271 (TOWER 1)

AMENITIES

Hang out with friends at the lounge, or outdo yourself at the gym. Soak up the sun by the pool, or bond with your kids at the play area. There's a little bit of everything for everyone!

- Open Lounges
- Children's Play Area
- Lap Pool
- Kiddie Pool
- Indoor Gym
- Clubhouse



Artist's Perspective



Artist's Perspective



Artist's Perspective

TYPICAL FLOOR PLAN TOWER 1

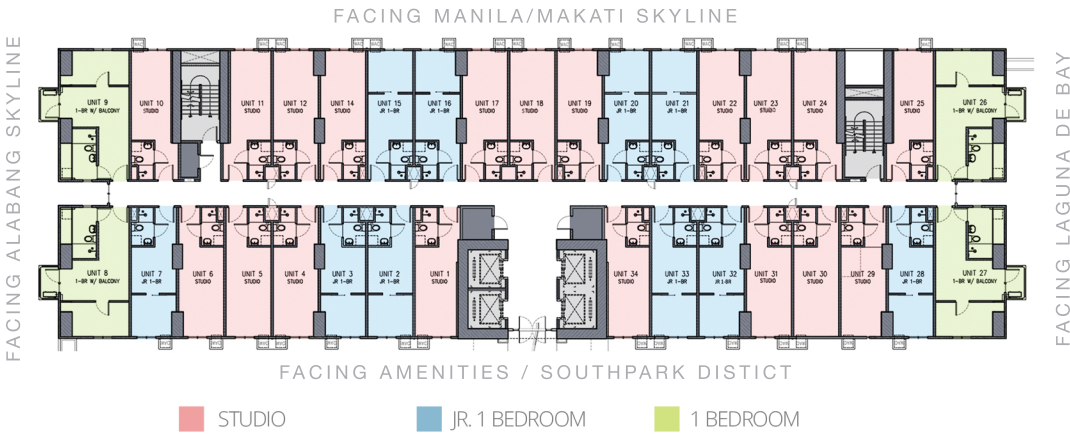

STUDIO*

STUDIO	SQ.M.
Living/Dining/Kitchen	19.80
Toilet and Batch	3.50
Estimated Total Area	23.30

JR 1 BEDROOM*

JR 1 BEDROOM	SQ.M.
Living/Dining/Kitchen	12.10
Toilet and Batch	3.50
Bedroom	7.70
Estimated Total Area	23.30

1 BEDROOM*

1 BEDROOM	SQ.M.
Living/Dining/Kitchen	19.10
Toilet and Batch	5.30
Bedroom	11.30
Balcony	2.50
Estimated Total Area	38.2

*Artist's Perspective



Artist's Perspective



Artist's Perspective