

ADELAIDA PARK RESIDENCES
RE-OPENED : 98%
MAPLE

House type :	"complete / finished"
Lot Classification	regular
BLOCK	6
LOT	6
AREA, in sqm	90
TCP of House & Lot (VAT inclusive)	P5,500,000
<i>add: Miscellaneous fee, 7.5 %</i>	P412,500
TOTAL	P5,912,500

RESERVATION FEE	Day 1	P150,000
------------------------	--------------	-----------------

SPOT CASH IN 6 MONTHS

100% tcp + MISC.	P5,912,500
Less : Reservation Fee	-P150,000
Balance , net of RF covered PDC's	P5,762,500

Month 1-6	P960,416.67
-----------	--------------------

- 1 Reservation Fee is non-refundable and non-transferable. It forms part of equity.
- 2 with Value Added Tax (VAT). Price is subject to change without prior notice.
In case of typographical errors, A Brown Company, Inc. reserves the right to correct the figures in this proposal.
- 3 Total Contract Price excludes cost of retitling fee. Processing expenses and taxes are subject to change based on the government mandated rates. The estimated cost of retitling fee will be billed once the account is fully paid.
- 4 Postdated checks required
- 5 All checks should be made payable to A BROWN COMPANY, INC.

Maple MODIFIED



HOUSE FEATURE:
Maple Modified Second Floor
2 Bedrooms
Common Toilet and Bath
Terrace

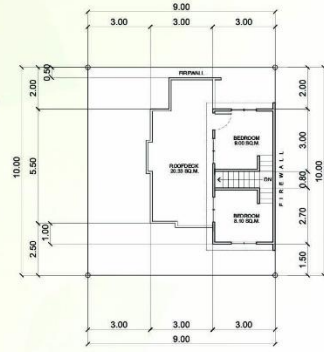

SECOND FLOOR PLAN
SCALE: 1:1000
Floor Area: 19.52 sq.m.

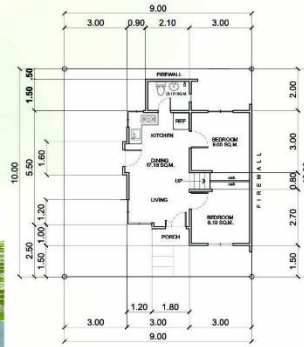

HOUSE FEATURE:
Maple Modified Ground Floor
Carport
Porch
Living, Dining, Kitchen
Common Toilet and Bathroom
2 Bedrooms

Lot Area : 90 sq. m.
Total Floor Area: 103.83 sq.m.
Walled Area : 59.50 sq.m.
Open Area : 20.33 sq.m.

GROUND FLOOR PLAN
SCALE: 1:1000
Floor Area: 39.98 sq.m.

Adelaida

PARK RESIDENCES
UPPER BALULANG, CAGAYAN DE ORO CITY
BESIDE XAVIER ESTATES

- SD - Single Detached
-  - Sold Properties
-  - Unsold Properties

TO VENTURA RESIDENCES
↑

TO XAVIERVILLE
↑



UPDATED AS OF JULY 20, 2022