



Symfoni Kamias

Horizons 101

Taft East Gate

Mandani Bay

Soltana Nature Residences

Symfoni Nichols

THE  
**TAFT**

D I F F E R E N C E

# THE SIX TAIPANS OF CEBU

*Did you know that some of the big names in today's Philippine business hail from Cebu?*

*The 445-year-old city is considered a bustling center of commerce and trade outside of the country's capital, Manila. The potential of the province did not go unnoticed to these enterprising immigrants and Filipinos, who surmounted all odds and built the business empires they are now known for.*

## THE GOKONGWEIS



FATHER AND SON. (From left) Lance and John Gokongwei Jr. grace the arrival ceremony of its 2nd Airbus A330-300 aircraft on September 12,

## THE LHUILLIERS



FROM PAWNBROKING TO MONEY REMITTANCE. A Cebuana Lhuillier Pera Padala branch in Angeles City, Pampanga. Image from Wikipedia

## THE GAISANOS



THE 'AYALA' MALL OF THE SOUTH. Gaisano mall in Cagayan De Oro. Image from Wikipedia

## THE GOS



ENTREPRENEURIAL VOYAGE. The Gos' MV Princess of the South. Image from Wikipedia

## THE ABOITIZES



CARRYING ON THE LEGACY. (Seated) Ana Aboitiz-Delgado, Rafa de Mesa; (Standing from left) Carlos Aboitiz, Tristan Aboitiz, William Paradies. File photo by Peter Imbong

## THE GOTIANUNS



INTO BANKING. Gotianun also runs East West Bank, among its other business interests. Image from the Filinvest Group website



# The Gaisanos: From Retail to Real Estate

*Taking off from their matriarch's legacy and love for Cebu, the Gaisano family of Cebu breaks through from retail to real estate with astounding success.*

*The Gaisano family is called the Ayalas of the South for operating malls across Visayas and Mindanao since the 1970s.*

*1970s. Doña Modesta Gaisano opened a small restaurant-cum-shop in Colon, Cebu, which would become the White Gold Department Store, the predecessor of Gaisano Malls.*

*1981. After the death of Doña Modesta, her sons David, Stephen, Henry, Victor, and John divided their corporation and operated their own Gaisano Malls.*

*Run today by second-generation Gaisanos, their malls now include Metro Gaisano, Gaisano Country Malls, and the Gaisano Capital Group.*

# THE GAISANO LEGACY IN CEBU AND THE PHILIPPINES IS DEEP AND WIDE





RETAIL



PROPERTIES

VIC S A L  
DEVELOPMENT CORPORATION



MALL OPERATIONS



FINANCIAL SERVICES



# So Who Is Taft?

*Taft Properties is the Property Development Arm of the Gaisano Family of Cebu*

## The Taft Logo Anatomy

The stylized "A" is an abstract roof symbolizing property development. It can also be perceived as an arrowhead pointing skywards, illustrating progress.



The Taft Properties logo encapsulates the company's vision of creating developments of superior quality.

A contemporary typeface asserts Taft Properties' commitment to keeping things clean and simple.

The bold emphasis and wide spacing represent stability and strength. Black and tangerine were chosen for their associations with boldness, creativity, and determination, and the complementary colors represent harmonious communities that emerge from Taft Properties' well-planned developments.

The "O" as a target icon represents a promise to consistently create quality and sustainable projects.



# THE COMPLETE PACKAGE: Taft Properties' MicroTownship

*The MicroTownship ideal has best come to life at Taft East Gate, Taft Properties' mixed-use development located right next to Cebu Business Park. Integrating residential, commercial, and hotel components into one dynamic space that is within close range of some of the city's most popular destinations, Taft East Gate is the very definition of having it all.*



Architectural rendering



### LIVE

Experience life to the fullest at a complete community.



### MOVE

Easily get to anywhere else from your prime address, saving you from the hassles of commuting or waiting.



### WORK

Live conveniently close to your place of work.



### SHOP

Retail therapy is often a few steps away.



### LEARN

Absorb the energy of a place that's rich in activities to explore and discover.



### SUSTAIN

Be part of communities that are built to respect nature, helping to make modern lifestyles sustainable and ecologically sound.



### PLAY

Find your heart's delight close by, with lush gardens and social spaces.





**Lower Light Switches**

The ability to turn the lights on or off becomes accessible to every family member.



**Door Card Access System**

This system provides an easy and sophisticated solution to home security.



**Under-stair Storage**

Every space available is maximized for your growing needs.

**Elevator Key Card Access System**

Building security is enhanced by a system that limits floor access to its residents.



**No-drip Countertops**

Raised edges on sink countertops prevent spills from reaching the floors.



**Fast-drain Technology**

The shower area is kept clean and ponding becomes a thing of the past.



**Toddler Handrails**

This safety feature helps to make home a safe environment for the little ones.



**Lever-type Door Handles**

Requiring less effort to operate than doorknobs, these handles make opening doors easier.



**Motion-activated Light**

For a safe and convenient experience, lights come on as soon as a resident enters their unit.

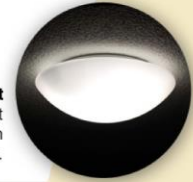

**Standard-sized Modern Design Fireboard Doors**

Made of engineered wood, these doors are not only durable, but also more environment-friendly.



**3-person-use Toilet & Bath**

Wait no longer as separate areas for toilet and bath allow them to be used simultaneously.



**Soft-close Cabinets**

The sound of banging cabinet doors is eliminated with soft-close hinges.



**Bidet Attachment**

A simple bathroom accessory makes a world of difference in hygiene.



*Small details*

*might be*

*overlooked in*

*grand designs; but*

*often, the tiniest*

*detail is the one*

*thing that makes a*

*project truly stand*

*out.*

# Crafted Comfort

**DISCLAIMER**  
Every development has its own combination of Comfort by Design features, ensuring that every element suits your needs, just as is intended.





Symfoni  
KAMIAS



Symfoni  
NICHOLS



HORIZONS  
CEBU



TAFT EAST GATE  
CEBU



Mandani  
Bay



SOLTANA  
Nature Residences

CITATION  
RESIDENCES





# Premium Places

Offering an exceptional standard of living, these properties cater to the tastes of a discerning few.



# Cozy Spaces

Life's essentials are enhanced in these properties in order to meet the demands of an upwardly mobile market.

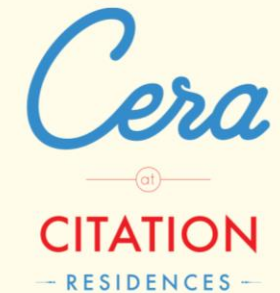



# Premium Places

Offering an exceptional standard of living,  
these properties cater to the tastes of a discerning few.





## STALWART IN BUILD, STEEP IN STYLE

It can be said that Horizons 101 is an ode to the unshakable Cebuano spirit—tall and proud, but firmly rooted in integrity.



*Horizons 101 stands at 173 meters above sea level and is the tallest building in Visayas and Mindanao*



# Sinulog

Horizons 101 is right along the Parade Route of the Sinulog Mardigras



*Designed in compliance with National Structural Code of the Philippines which is patterned after/equivalent to the American Code Institute, Horizons 101 has withstood the Bohol earthquake at magnitude 7.2 in October 2013.*

## *Building Features*

*4 High-speed Elevators*

*100% Back-up Power*

*Sky Gardens*

*Elevator Key Card Access*

*Strategically Located CCTVs*





# Quick Facts

960 units on 55 floors in Tower 1  
689 units on 46 floors in Tower 2  
340 parking units for Tower 1  
216 parking units for Tower 2  
4,111-square meter lot area



Actual Photo of Show Gallery

# *Amenities*

*Lap Pool with Covered Deck*

*Kiddie Pool*

*Play Area*

*Fitness Gym*

*Multipurpose Room*

*Indoor Game Room*

*Commercial Area*

*Garden*

*Jacuzzi*

*Exercise Station*

*Billiard Room*

*AV Room*

*Day Care Center*



*Actual Photo of AV Room*



*Actual Photo of Kiddie Pool & Lap Pool with Covered Deck*



*Actual Photo of Billiard Room*



*Actual Photo of Multi-Purpose Room*



*Tower 1 Units*

*Actual Photo*





Actual Photo







*Premium Floors*  
*51st to 53rd, 15 units per floor*  
*54th to 55th, 8 units per floor*

*Mid Zone*  
*26th to 50th*  
*22 units per floor*

*Low Zone 9th to 25th*  
*24 units per floor*



LOW ZONE

# Typical Building Floor Plans

## Tower 1

Sea Horizon

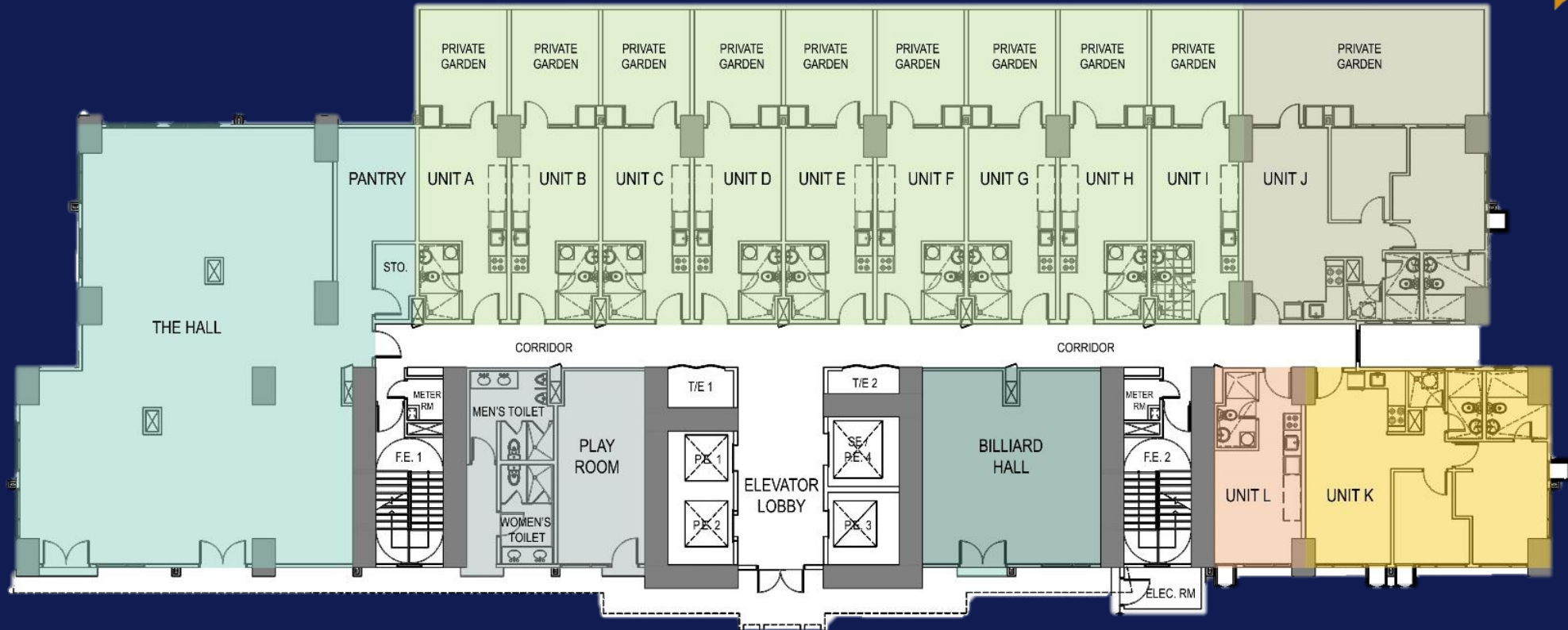

Mountain Horizon

**LOW ZONE**

Amenity Floor - 9<sup>th</sup> Floor

- Studio Unit
- Studio Garden Unit
- Two-bedroom Unit
- Two-bedroom Garden Unit
- Multi-Purpose Hall
- Play Room
- Billiard Hall

# Typical Building Floor Plans

## Tower 1

Sea Horizon

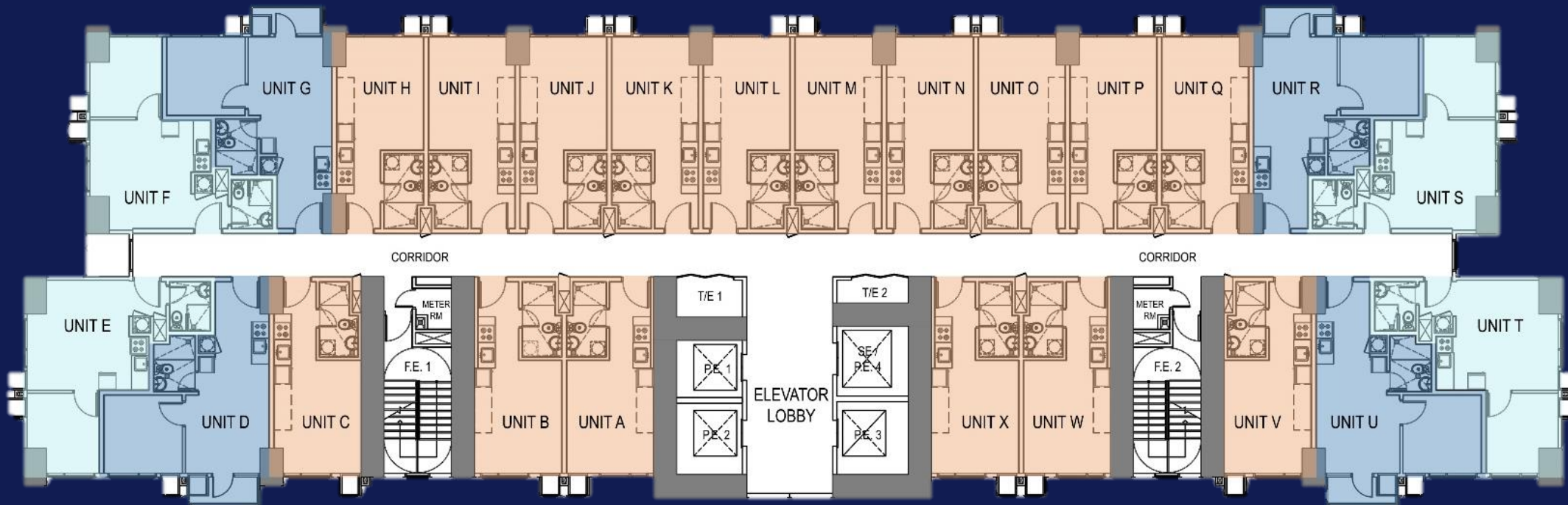

Mountain Horizon

-  Studio Unit
-  One-bedroom Corner Unit
-  One-bedroom w/ Balcony Unit

**LOW ZONE**

10<sup>th</sup> to 15<sup>th</sup>, 18<sup>th</sup> Floor Plan w/ Balcony

# Typical Building Floor Plans

## Tower 1

Sea Horizon

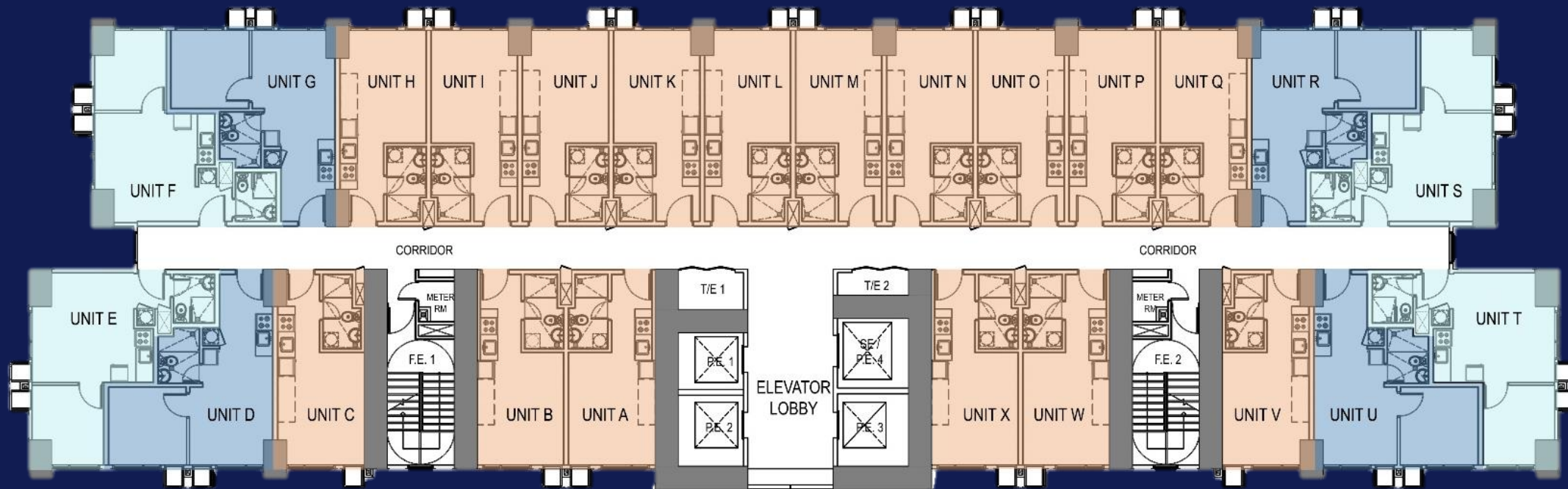

Mountain Horizon

- Studio Unit
- One-bedroom Corner Unit
- One-bedroom

**LOW ZONE**

16<sup>th</sup> to 17<sup>th</sup> Floor, 19<sup>th</sup> to 25<sup>th</sup> Floor Plan



# MID ZONE

# Typical Building Floor Plans Tower 1

Sea Horizon

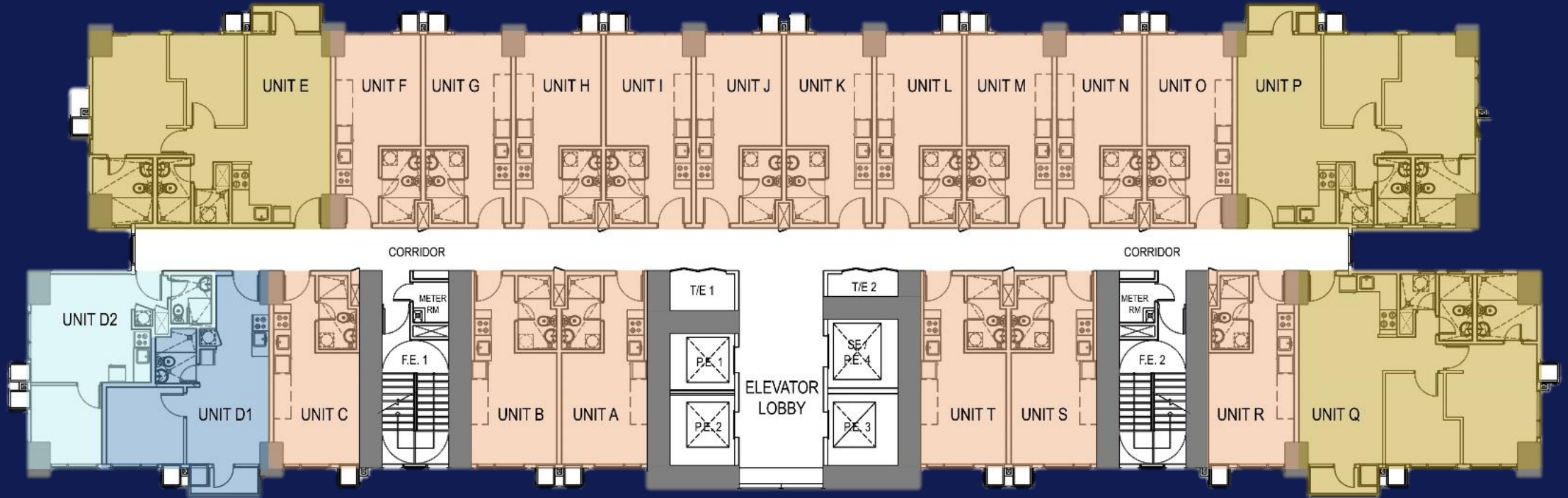

Mountain Horizon

- Studio Unit
- One-bedroom Corner Unit
- One-bedroom w/ Balcony Unit
- Two-bedroom w/ Balcony Unit

**MID ZONE**  
26<sup>th</sup> Floor Plan



# Typical Building Floor Plans

## Tower 1

Sea Horizon

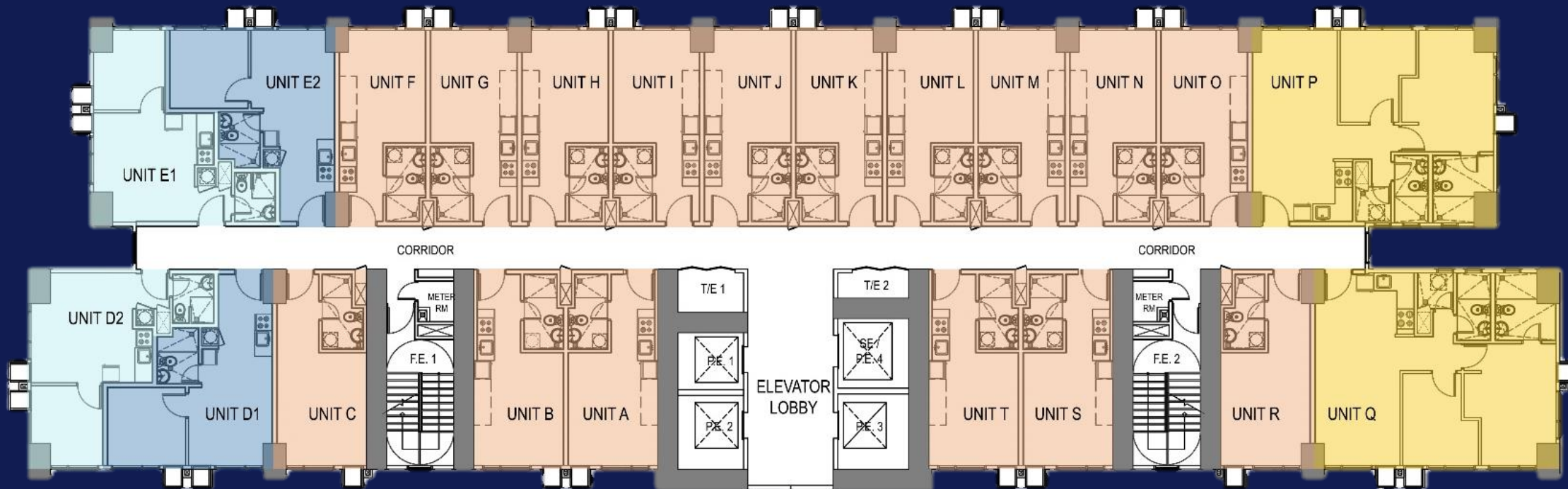

Mountain Horizon

- Studio Unit
- One-bedroom Corner Unit
- One-bedroom Unit
- Two-bedroom Unit

**MID ZONE**

27<sup>th</sup>, 29<sup>th</sup> to 30<sup>th</sup>, 32<sup>nd</sup> to 37<sup>th</sup>, 39<sup>th</sup> to 40<sup>th</sup> Floor Plan

# Typical Building Floor Plans

## Tower 1



Sea Horizon

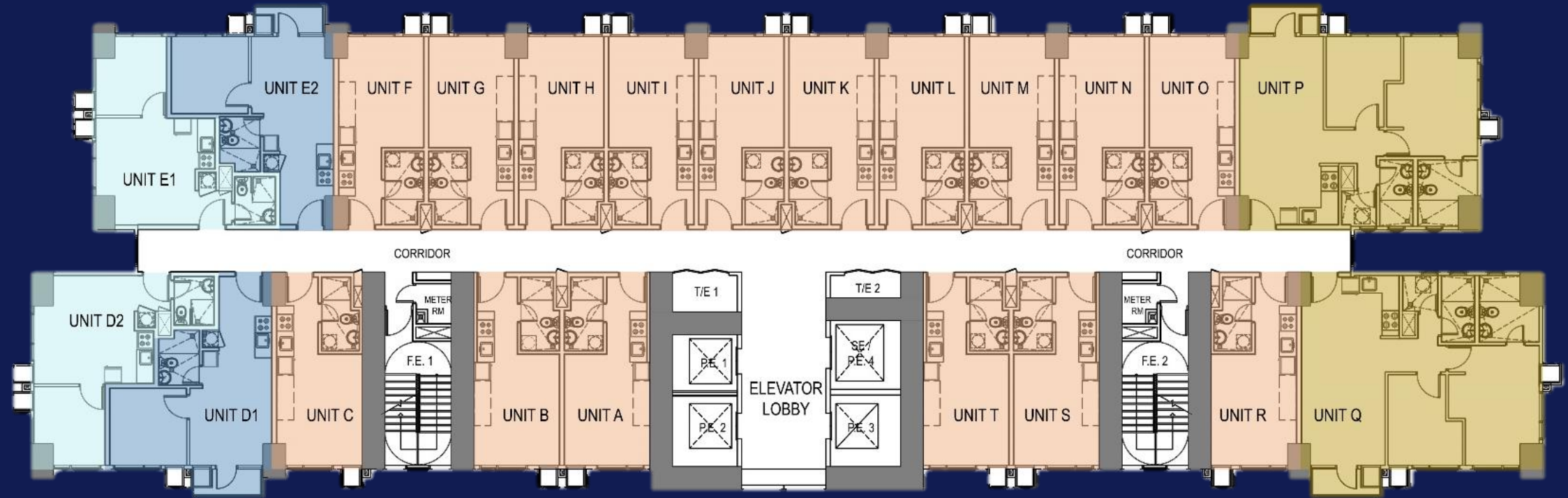

Mountain Horizon

- Studio Unit
- One-bedroom Corner Unit
- One-bedroom w/ Balcony Unit
- Two-bedroom w/ Balcony Unit

**MID ZONE**

28<sup>th</sup>, 31<sup>st</sup> and 38<sup>th</sup> Floor Plan w/ Balcony

# Typical Building Floor Plans

## Tower 1



Sea Horizon

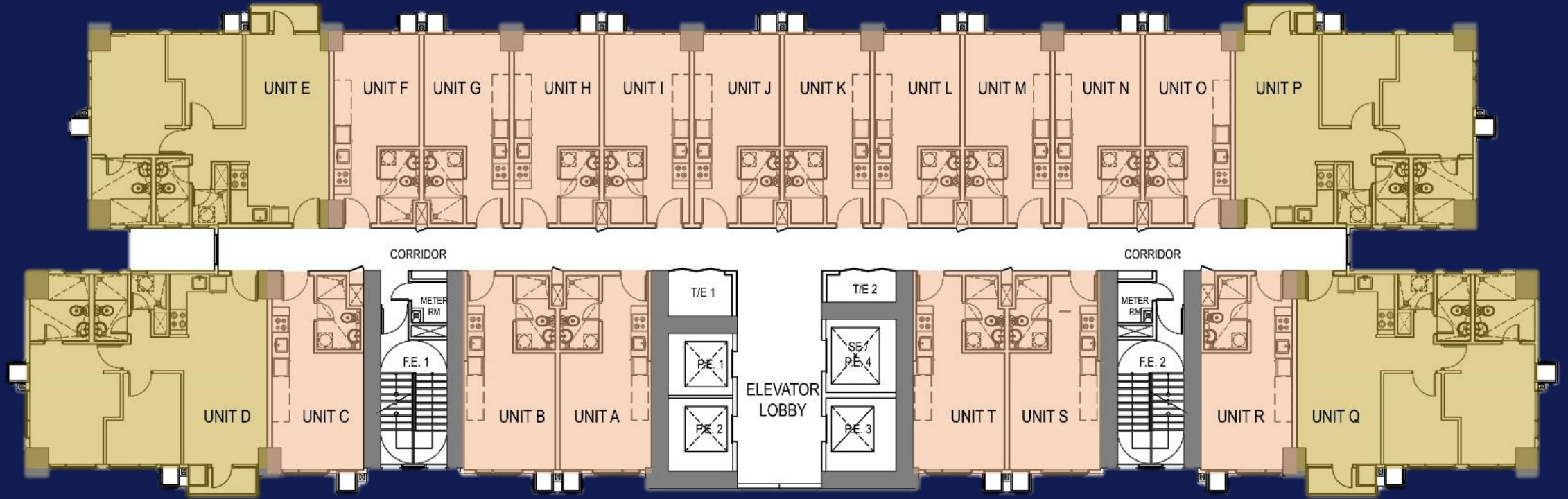

Mountain Horizon

- Studio Unit
- Two-bedroom w/ Balcony Unit

### MID ZONE

41<sup>st</sup> and 43<sup>rd</sup> Floor Plan w/ Balcony

# Typical Building Floor Plans

## Tower 1



Sea Horizon

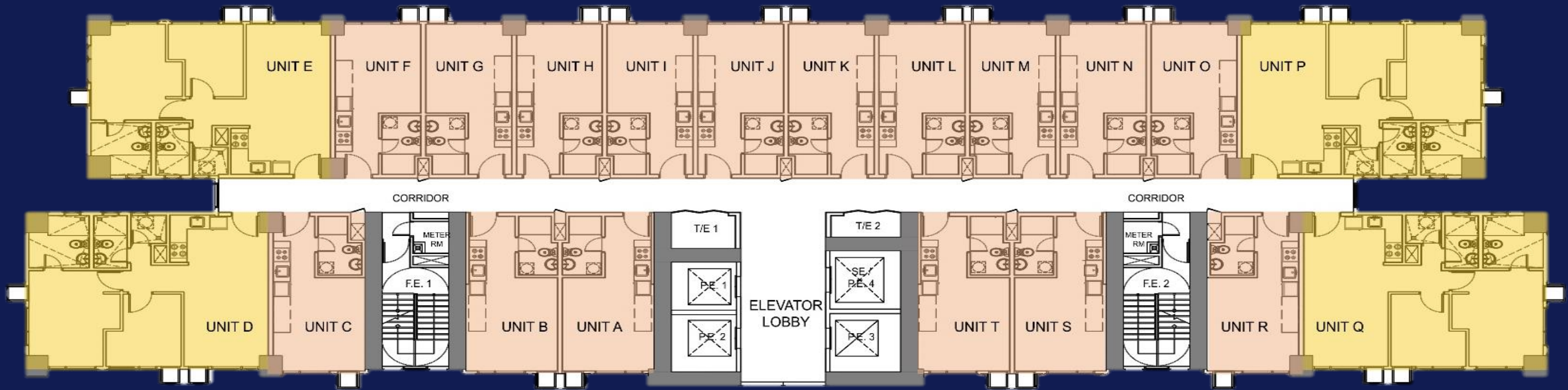

Mountain Horizon

### MID ZONE

42<sup>nd</sup>, 44<sup>th</sup> to 46<sup>th</sup> Floor Plan

- Studio Unit
- Two-bedroom Unit



# PREMIUM FLOORS

*Actual Photo*

# Typical Building Floor Plans



## Tower 1

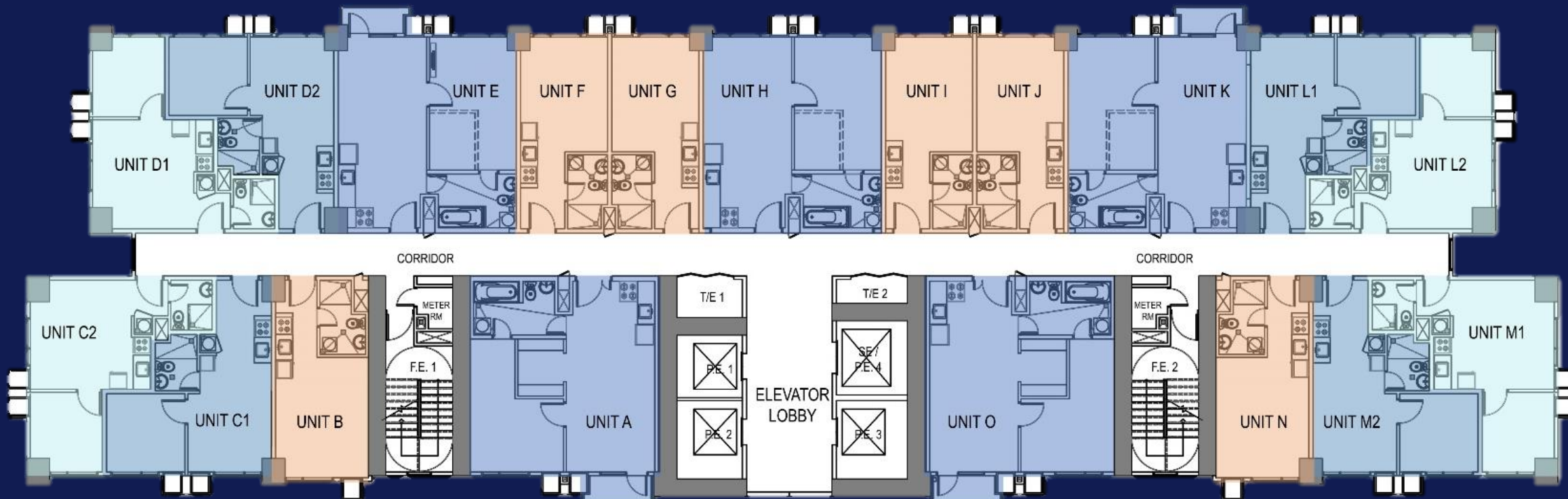

Sea Horizon

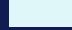

Mountain Horizon

-  Studio Unit
-  One-bedroom Corner Unit
-  One-bedroom Unit
-  One-bedroom Suite Unit

**PREMIUM FLOOR**

47<sup>th</sup> to 50<sup>th</sup> Floor Plan

# Typical Building Floor Plans

## Tower 1



Sea Horizon

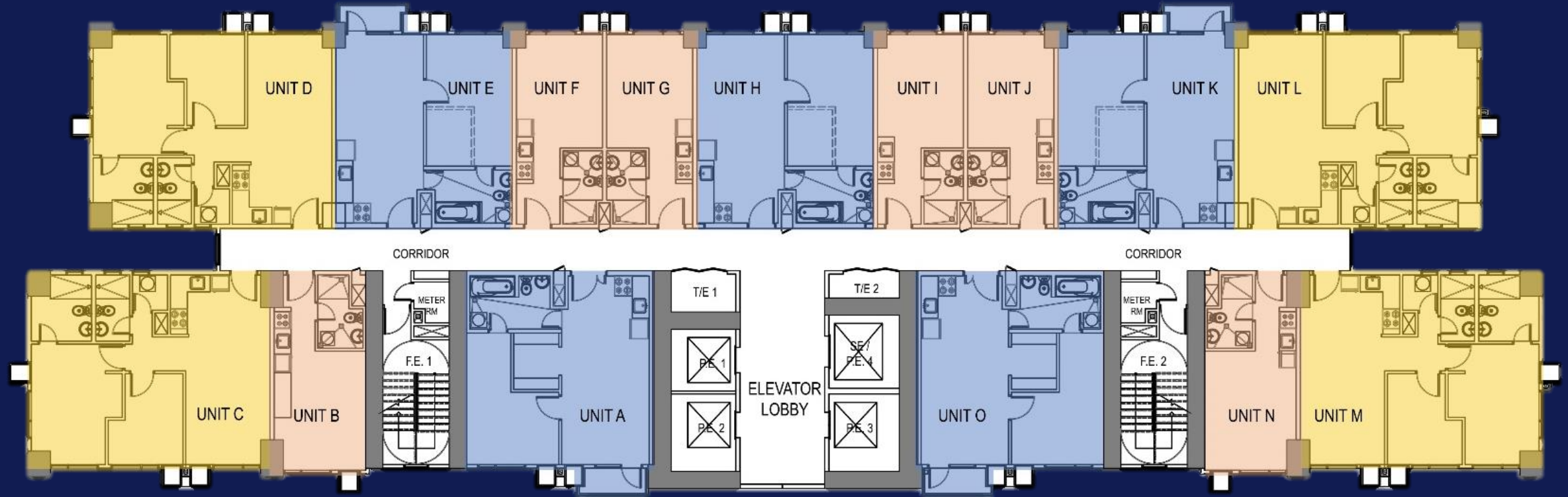

Mountain Horizon

-  Studio Unit
-  One-bedroom Suite Unit
-  Two-bedroom Unit

**PREMIUM FLOOR**  
51<sup>st</sup> to 53<sup>rd</sup> Floor Plan

# Typical Building Floor Plans

## Tower 1



Sea Horizon

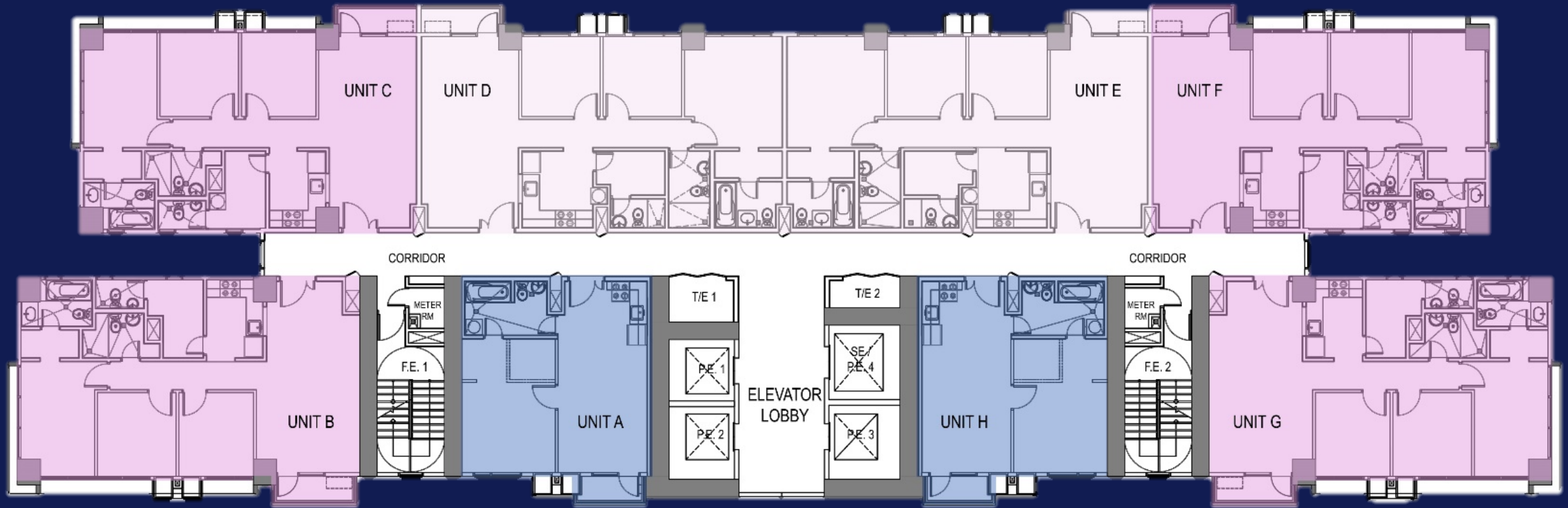

Mountain Horizon

-  One-bedroom Suite Unit
-  Three-bedroom Unit
-  Three-bedroom Corner Unit

**PREMIUM FLOOR**

54<sup>th</sup> Floor Plan



# Typical Building Floor Plans

## Tower 1



Sea Horizon



Mountain Horizon

**PREMIUM FLOOR**

Penthouse Floor – 55<sup>th</sup> Floor Plan (Lower Loft)

- One-bedroom Suite Unit
- Three-bedroom Corner Unit
- Three-bedroom Loft Unit A
- Three-bedroom Loft Unit B
- Three-bedroom Corner Loft Unit

# Typical Building Floor Plans

## Tower 1



Sea Horizon

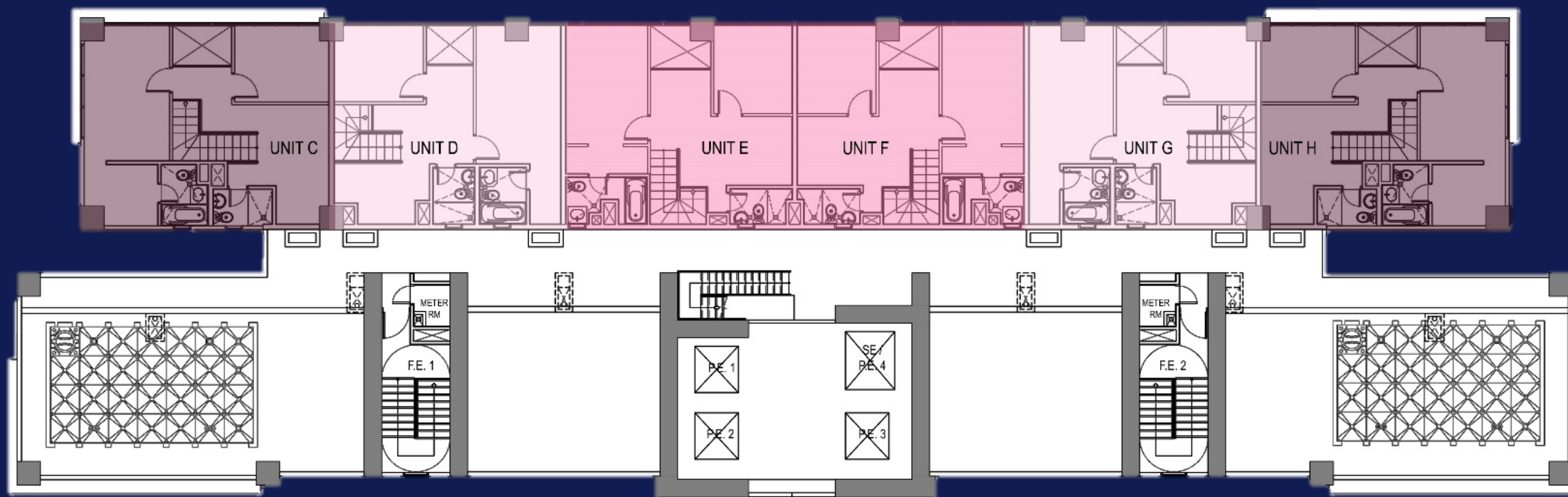

Mountain Horizon

- Three-bedroom Loft Unit A
- Three-bedroom Loft Unit B
- Three-bedroom Corner Loft Unit

**PREMIUM FLOOR**

Penthouse Floor – 55<sup>th</sup> Floor Plan (Upper Loft)



# Studio Unit

22.16 – 24.23 m<sup>2</sup>

*\*Details may change without prior notice*



# One-bedroom Unit

30.10 - 49.63 m<sup>2</sup>

*\*Details may change without prior notice*



# Two-bedroom Unit

62.85 m<sup>2</sup>

*\*Details may change without prior notice*



# Three-bedroom Unit

87.51 m<sup>2</sup>

*\*Details may change without prior notice*

# Typical Building Floor Plans

## Tower 2

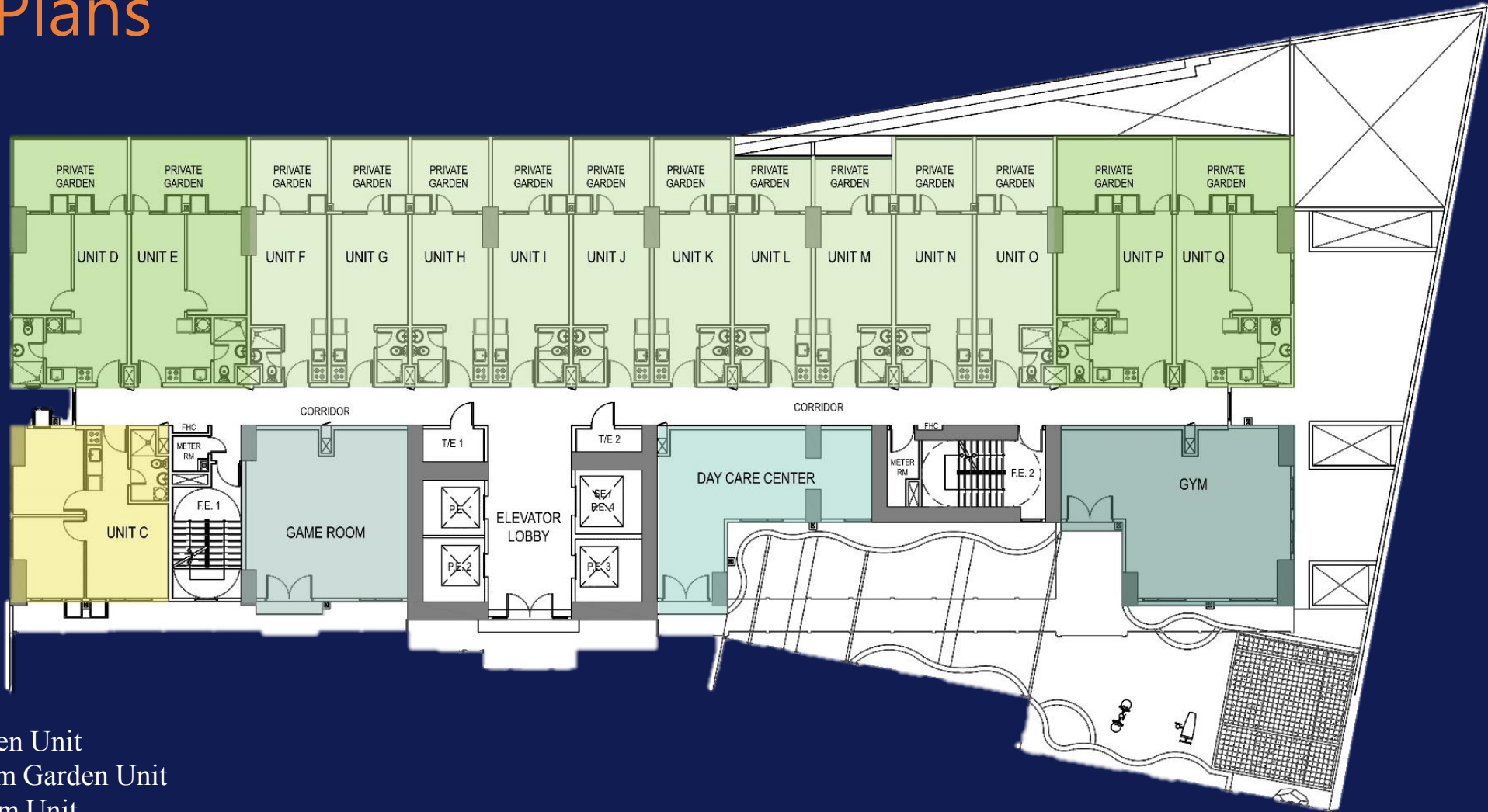

- Studio Garden Unit
- One-bedroom Garden Unit
- Two-bedroom Unit
- Day Care Center
- Game Room
- Gym

Amenity Floor - 9<sup>th</sup> Floor

# Typical Building Floor Plans

## Tower 2

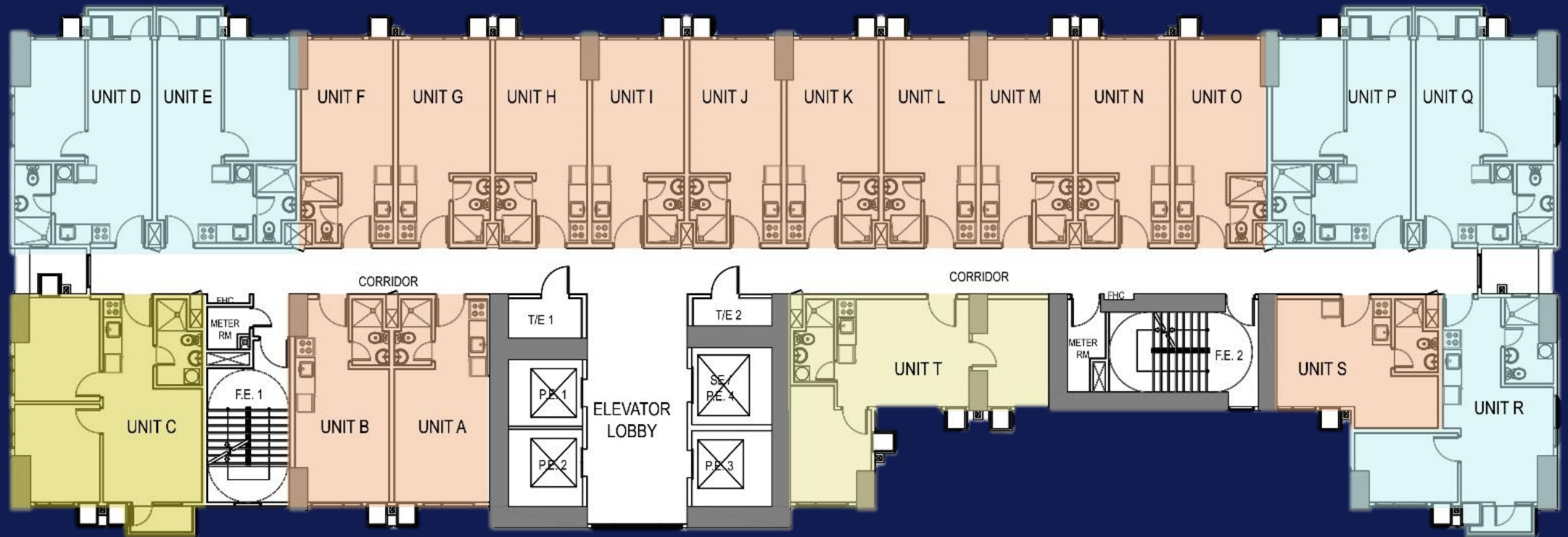

- Studio Unit
- One-bedroom w/ Balcony Unit
- Two-bedroom Unit
- Two-bedroom w/ Balcony Unit

10<sup>th</sup> to 18<sup>th</sup>, 22<sup>nd</sup> to 29<sup>th</sup> and 33<sup>rd</sup> to 40<sup>th</sup> Floor Plan



# Typical Building Floor Plans

## Tower 2

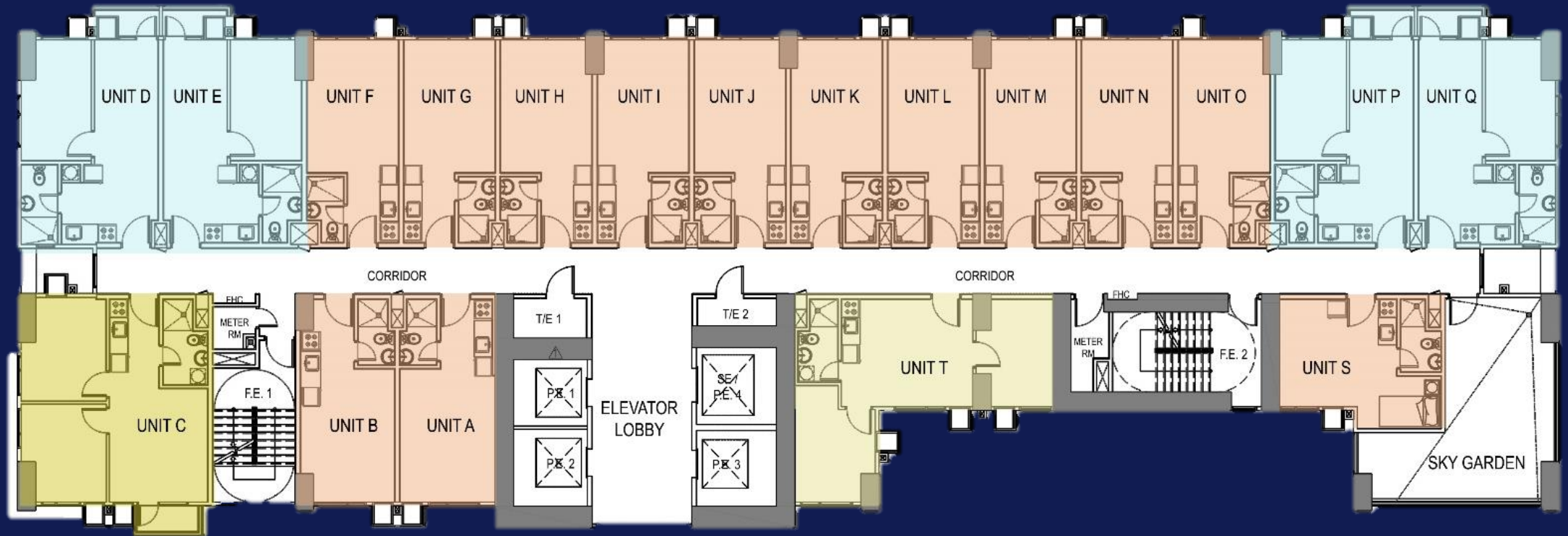

- Studio Unit
- One-bedroom w/ Balcony Unit
- Two-bedroom Unit
- Two-bedroom w/ Balcony Unit

19<sup>th</sup> and 30<sup>th</sup> Floor Plan (Sky Garden)

# Typical Building Floor Plans

## Tower 2

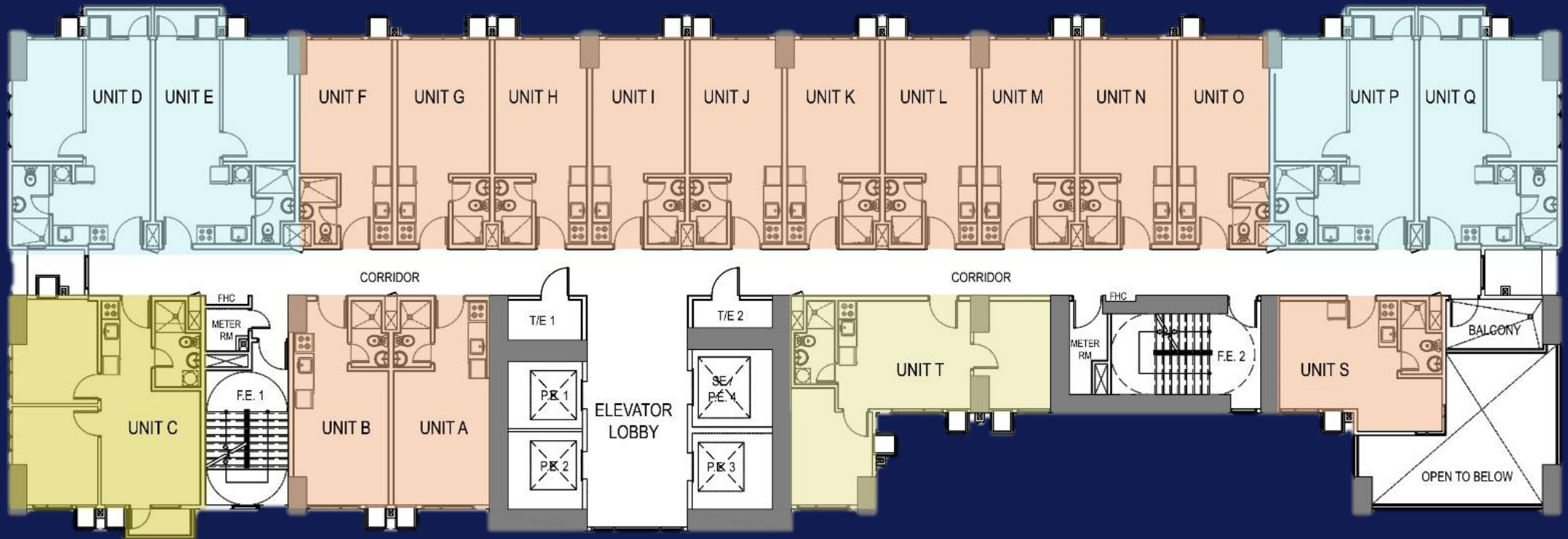





- Studio Unit
- One-bedroom w/ Balcony Unit
- Two-bedroom Unit
- Two-bedroom w/ Balcony Unit

20<sup>th</sup> to 21<sup>st</sup> and 31<sup>st</sup> to 32<sup>nd</sup> Floor Plan

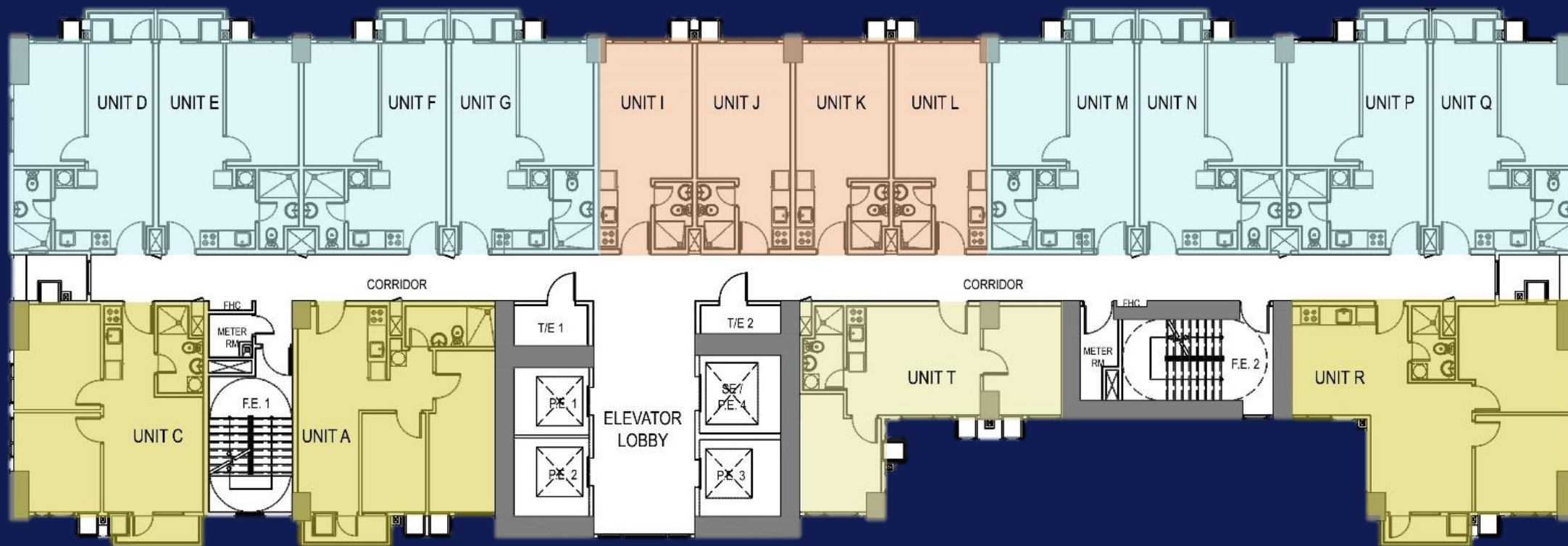
# Typical Building Floor Plans

## Tower 2



-  Studio Unit
-  One-bedroom w/ Balcony Unit
-  Two-bedroom Unit
-  Two-bedroom w/ Balcony Unit

41<sup>st</sup> and 46<sup>th</sup> Floor Plan

# Typical Building Floor Plans

## Tower 2

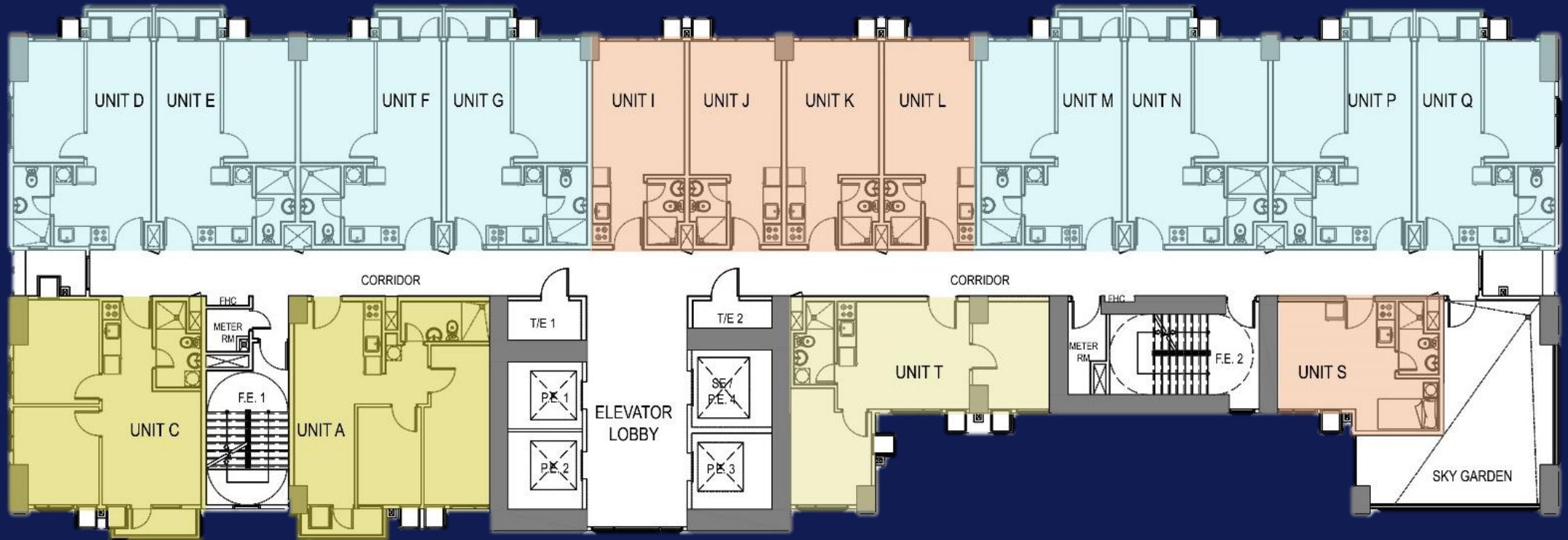





- Studio Unit
- One-bedroom w/ Balcony Unit
- Two-bedroom Unit
- Two-bedroom w/ Balcony Unit

42<sup>nd</sup> Floor Plan (Sky Garden)

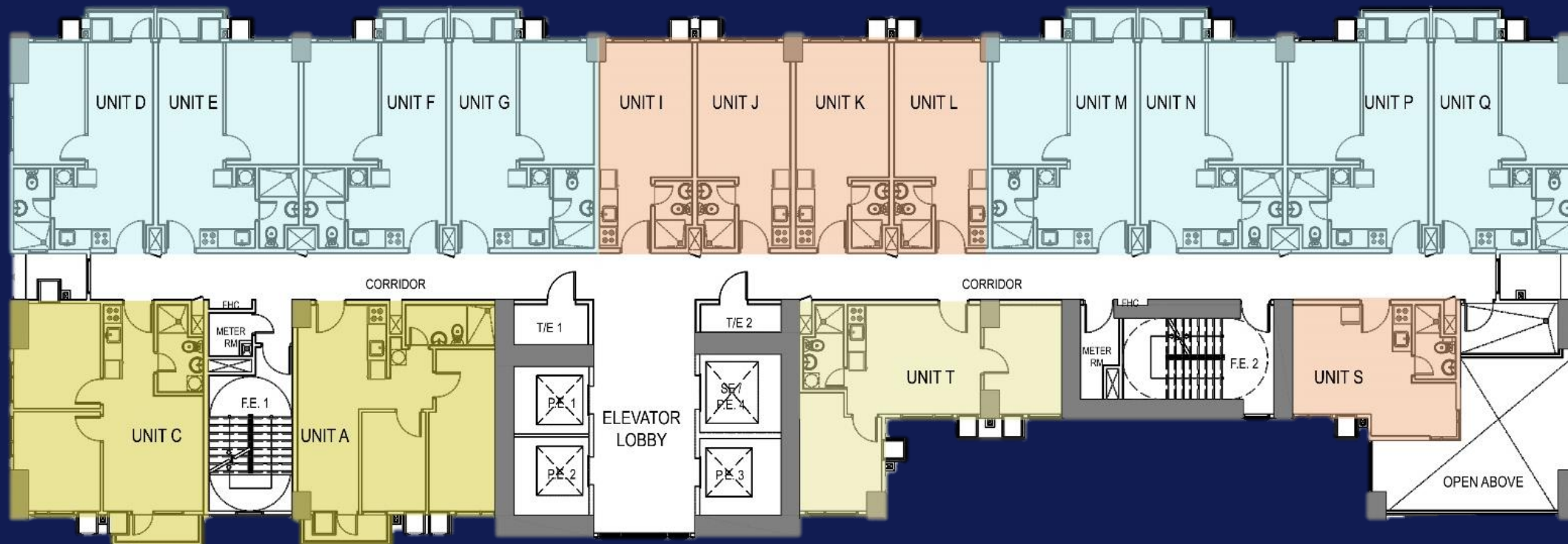
# Typical Building Floor Plans

## Tower 2

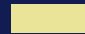

-  Studio Unit
-  One-bedroom w/ Balcony Unit
-  Two-bedroom Unit
-  Two-bedroom w/ Balcony Unit

43<sup>rd</sup> and 45<sup>th</sup> Floor Plan

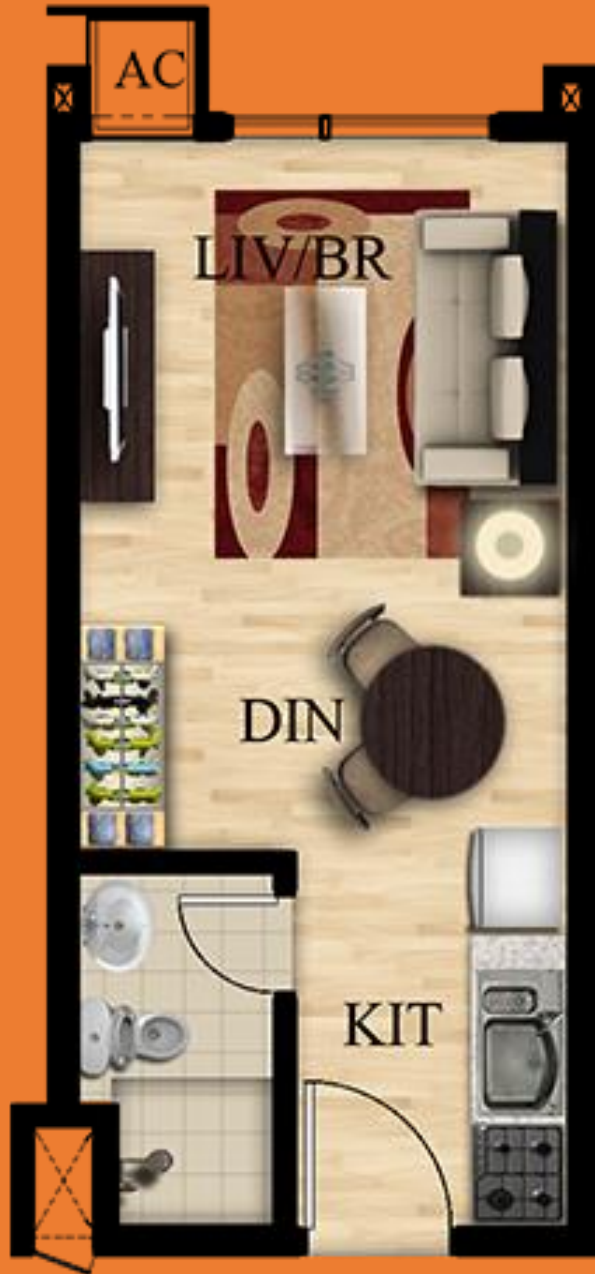

# Studio Unit

22.20 m<sup>2</sup>

*\*Details may change without prior notice*



# One-bedroom Unit

35.30 – 36.80 m<sup>2</sup>

*\*Details may change without prior notice*



## Two-bedroom Unit A

48.80 m<sup>2</sup>

*\*Details may change without prior notice*





## Two-bedroom Unit C

46.50 m<sup>2</sup>

*\*Details may change without prior notice*