

Amaia SERIES

VERMOSA



VERMOSA ESTATE

CONTEMPORARY ACTIVE LIVING, REDEFINED



Ayala Land once again will redefine community living for the next generation. Vermosa is a mixed-use destination that empowers an active lifestyle. The 700-hectare estate in Cavite brings together residential, retail, and business spots in one destination bolstered by fitness and amenities.

VERMOSA MIDTOWN



VERMOSA SPORTS HUB



AYALA MALLS VERMOSA



DE LA SALLE ZOBEL-VERMOSA



VERMOSA CHURCH



PARKS & OPEN SPACES



TRANSPORT TERMINAL

Amaia Series Vermosa is the first and only townhouse development in the modern suburban community in Vermosa Estate. The development is spacious in a variety of ways to inspire creativity among residents. It is built with energizing greens and open spaces with enriching features and amenities.



Cavite is one of the fastest growing province near Metro Manila. With its significant development, it has become attractive location for many businesses, investors, and even homebuyers.

Travelling to work and nearby places is just a minutes away as it is close to all major road networks: CAVITEX via Aguinaldo Highway, MCX and SLEX via Daang Hari road, and CALAX via Open Canal. Either you own a car or not, major transportation is also available in every corners of Cavite.

Amaia Series Vermosa is a property where you can reach the lifestyle that you and your family can enjoy. As it is located inside the Estate, getting into a nearby establishment is just a minutes away with its exclusive access road.





- ✓ Typhoon-resistant
- ✓ Fire-resistant
- ✓ Earthquake resistant

Amaia Series Vermosa is not just an affordable development. As we care for the safety of our future homeowners, Amaia made sure that the structural stability of each houses is fully compliant with all laws.

Amaia promotes a sustainable living environment to our homeowners by creating breathable open space, patio greens that collects rain water to replenish groundwater supply, and use of endemic plants.



NEW NORMAL HOME SET-UP

Staying at home and keeping your family safe and sound is the top priority nowadays. And a lot of us now understand how important is to live in a healthier surroundings.

Preparing your home to a more comfortable indoor space will definitely give us a peace of mind in the new normal setup.

Place your shoe racks/cabinets near door entry of your house.



Dedicate a workspace to adapt to the work-from-home lifestyle.



Open plans are intended for a ventilated space in order to get a connection to the life outdoor.

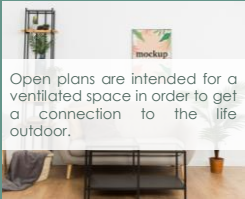

Cleanse your feet thoroughly upon entering you home.



Expansion area is suitable as a great laundry or sub storage area.



Have your own urban garden as a source of food and hobby.



Disinfectant mats could be a new norm in replacement of the regular door mats.



SPACIOUS LIVING SPACE



Spacious homes has changed to having more personal space and privacy. These two are the most important factors to maintain tranquility, peace, and harmony in the house and among the family members.

Here in Amaia Series Vermosa, each house are designed to fit the needs of your growing family.



TYPICAL GROUND FLOOR PLAN
SINGLE UNIT



TYPICAL SECOND FLOOR PLAN
SINGLE UNIT



TYPICAL GROUND FLOOR PLAN
DOUBLE UNIT



TYPICAL SECOND FLOOR PLAN
DOUBLE UNIT



FIRST-RATE AMENITIES



**VILLAGE
PAVILION**

**SWIMMING
POOL**



**BASKETBALL
COURT**



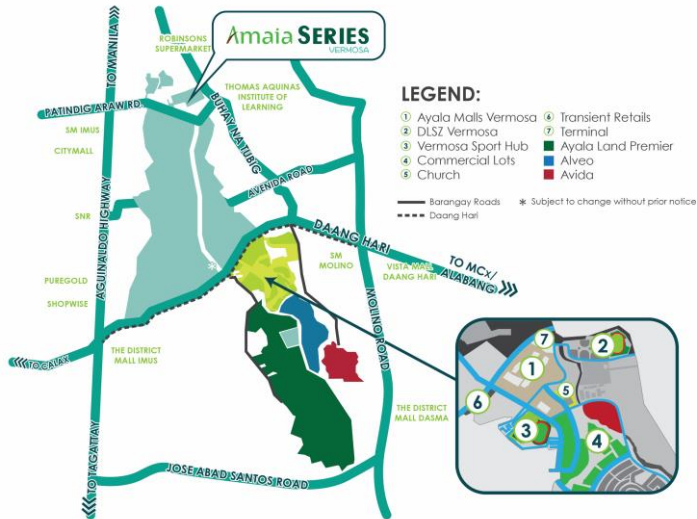

Amaia SERIES

VERMOSA

Patindig araw road, Brgy. Buhay na tubig, Imus, Cavite

LTS #: 034319

Date Issued: January 17, 2019

Completion Date: December 31, 2027

Ad Approval: AA-STR-012219-0021

Amaia Land Corp.

